

# les rideaux

A curtain is visible through the trees. Approaching, visitors see breaks in the fabric, shadows moving behind. Stepping through an opening leads to a passage with windows, exits, and entrances leading deeper, through a second curtain. Entering the inner room suggests an exhibition space, framing the surrounding garden in a series of snapshots; calling the visitors attention to the boundaries, both visible and intangible, which we place between ourselves and the natural world.

Les Rideaux is shrouded but never isolated from the surrounding gardens: clusters of native flowers spill under the curtains and spread blanket-like over the inner room; the branches of trees reach to form a canopy overhead. The visitor experience is shaped as much by nature as by the structure we have placed into it.

The curtain asks visitors to confront the lens through which they perceive nature and our relationship to it. Is it art, a place to visit and step inside, or something we are inherently a part of? Les Rideaux represents nature rolling into culture, culture folding in nature.



**Canada Goldenrod (Solidago Canadensis)**  
Native to Northeastern Canada, selected for its ability to attract pollinators like honeybees and monarch butterflies.



**Canadian Dwarf Cornel (Cornus Canadensis)**  
Native to North America, the carpet-like spread of this plant adds to the feeling of stepping into a room distinct from the wider gardens.



**Hairy Beardtongue (Penstemon Hirsutus)**  
Native to Eastern Canada, it thrives in dry soil and attracts hummingbirds and large numbers of native bees.



**White Wood Aster (Eurybia Divaricata)**  
Native but threatened in Canada with only 25 populations across the whole of Ontario and Quebec.

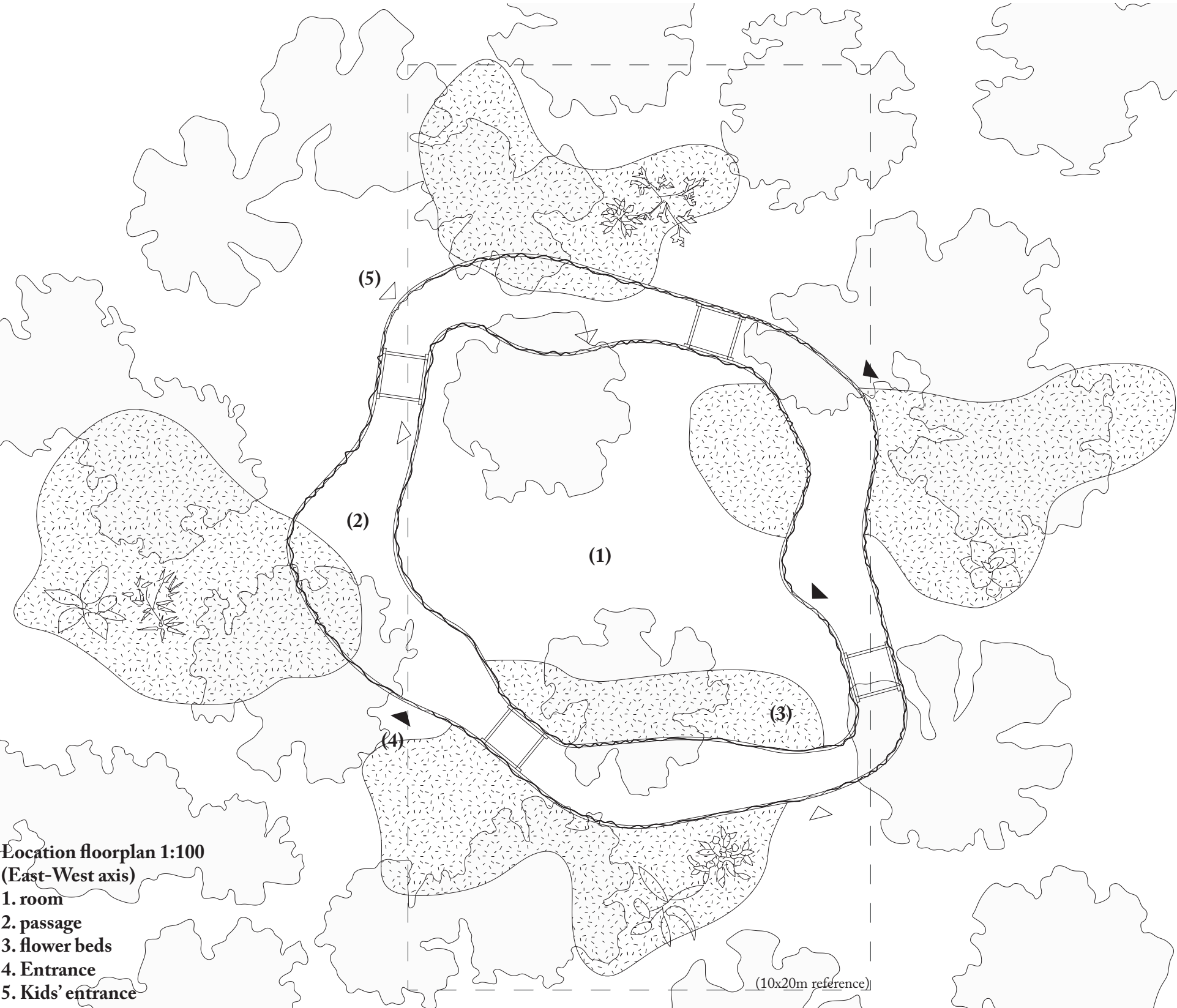

**Location floorplan 1:100 (East-West axis)**  
1. room  
2. passage  
3. flower beds  
4. Entrance  
5. Kids' entrance

(10x20m reference)



room



passage



materials

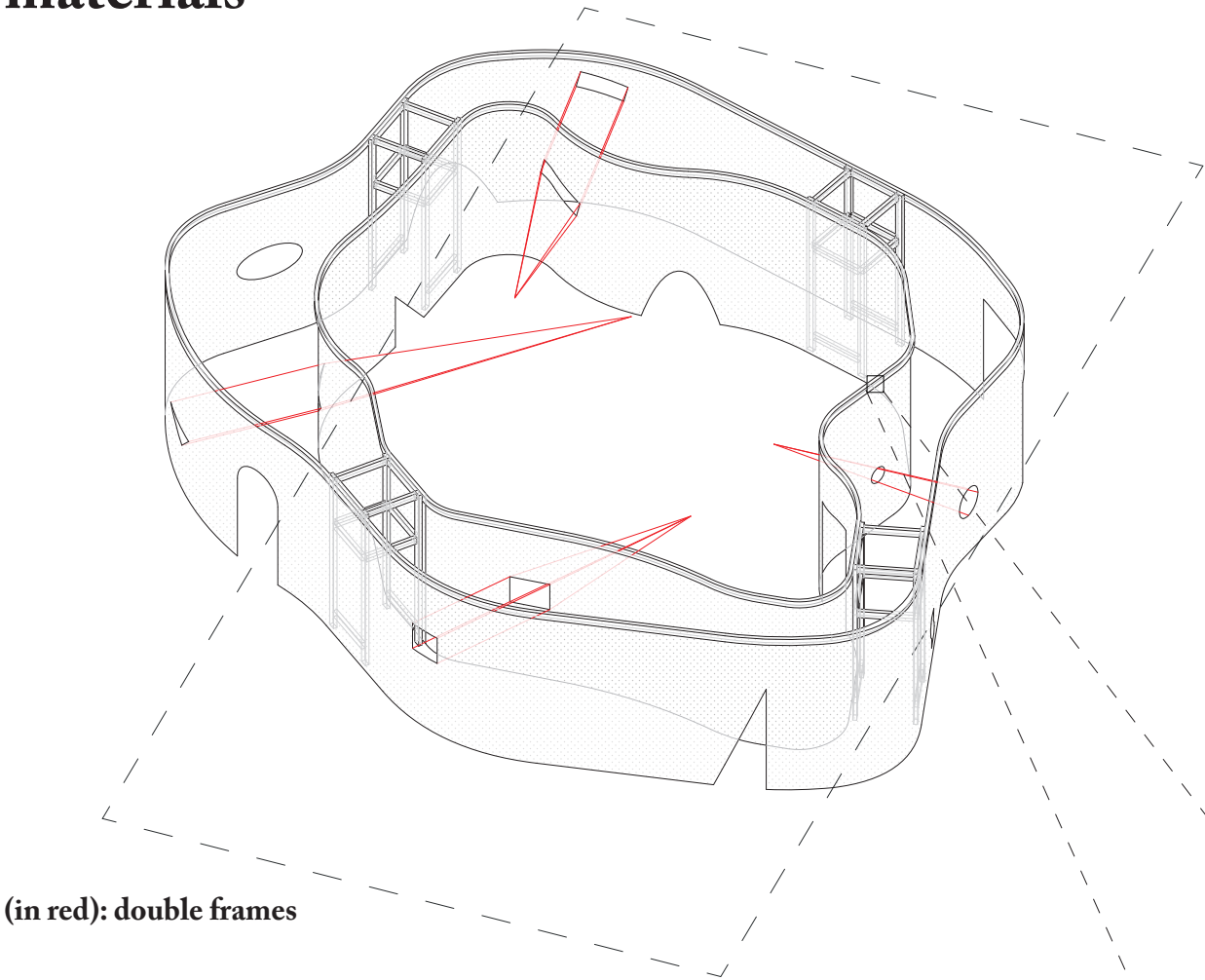

(in red): double frames

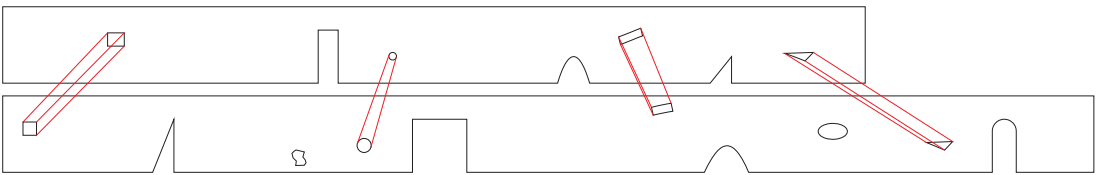

All materials can be repurposed after use, creating a minimal carbon footprint.

- 1. Structure  
Recycled timber , section 12x6cm
- 2. Fabric  
Untreated, recycled cotton canvas, naturally water resistant and biodegradable
- 3. Support  
Rope made from natural fibres

