

# CANOPIES OF POSSIBILITY

Our project addresses the very beginning of the Reford gardens, with materials reflecting the local spruce ecology and the basket design that speaks to the involvement of the fisherman community.

Spruce wood, which is the only material used for our entire project, establishes a harmonious connection between nature and structure. We aim to display nature in its purest form, growing under little to no human interventions and passive observation, spotlighting the active dialogue between the native flora and fauna.

Visitors are invited to gaze upwards, appreciating the woven forms while allowing their curiosity to guide them throughout the installation, as there is no clear path.

Over time, our design seamlessly integrates with the local ecology, as the seeds that are interwoven within these weaved forms are envisioned to fall to the ground and eventually bloom into a floral garden that is not yet understood -

as there are countless possibilities for what the installation may grow to be.

Therefore, we yearn to foster a dynamic interplay between possibility and nature through our design - connecting community and ecology through the natural environment.

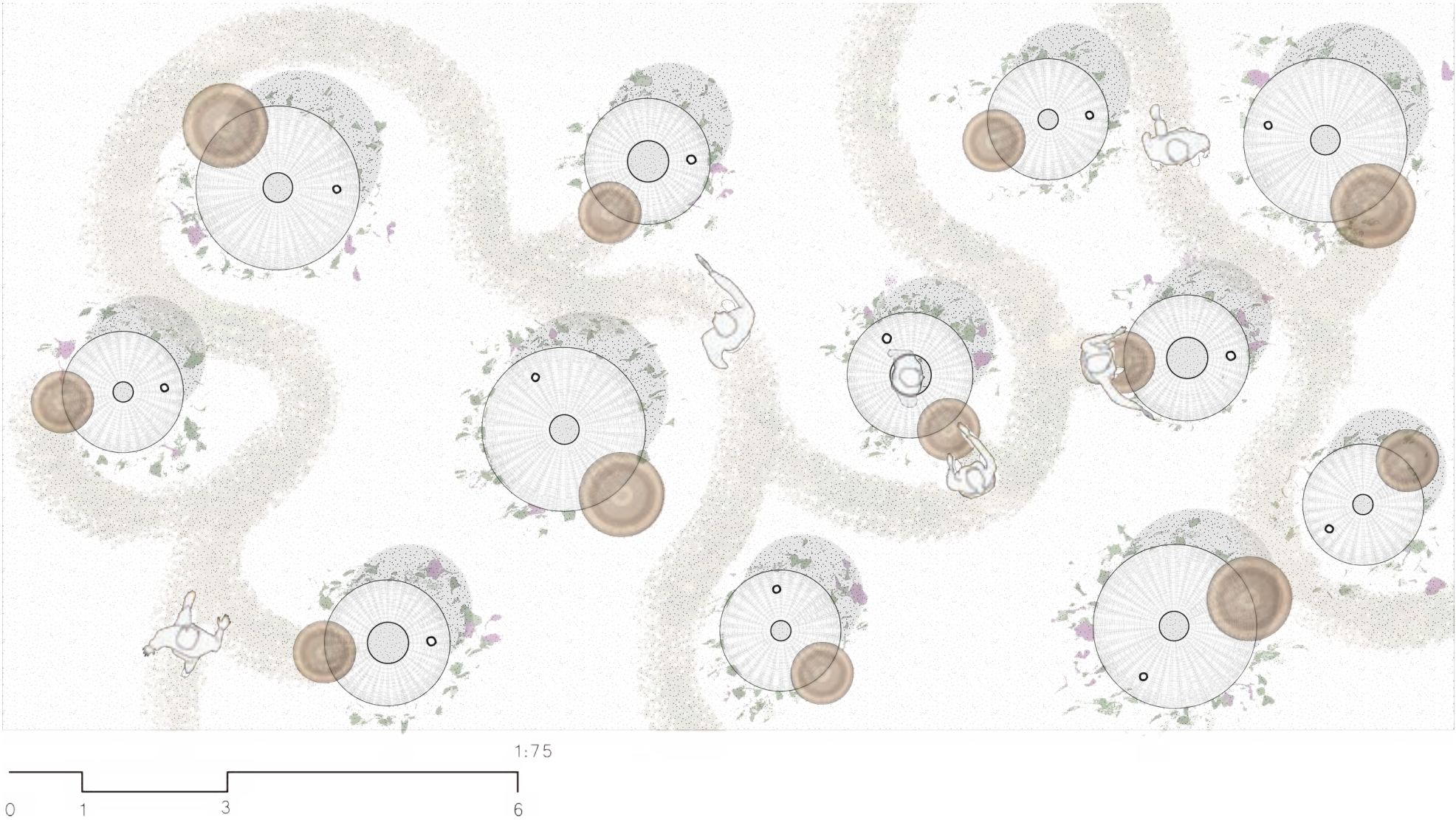
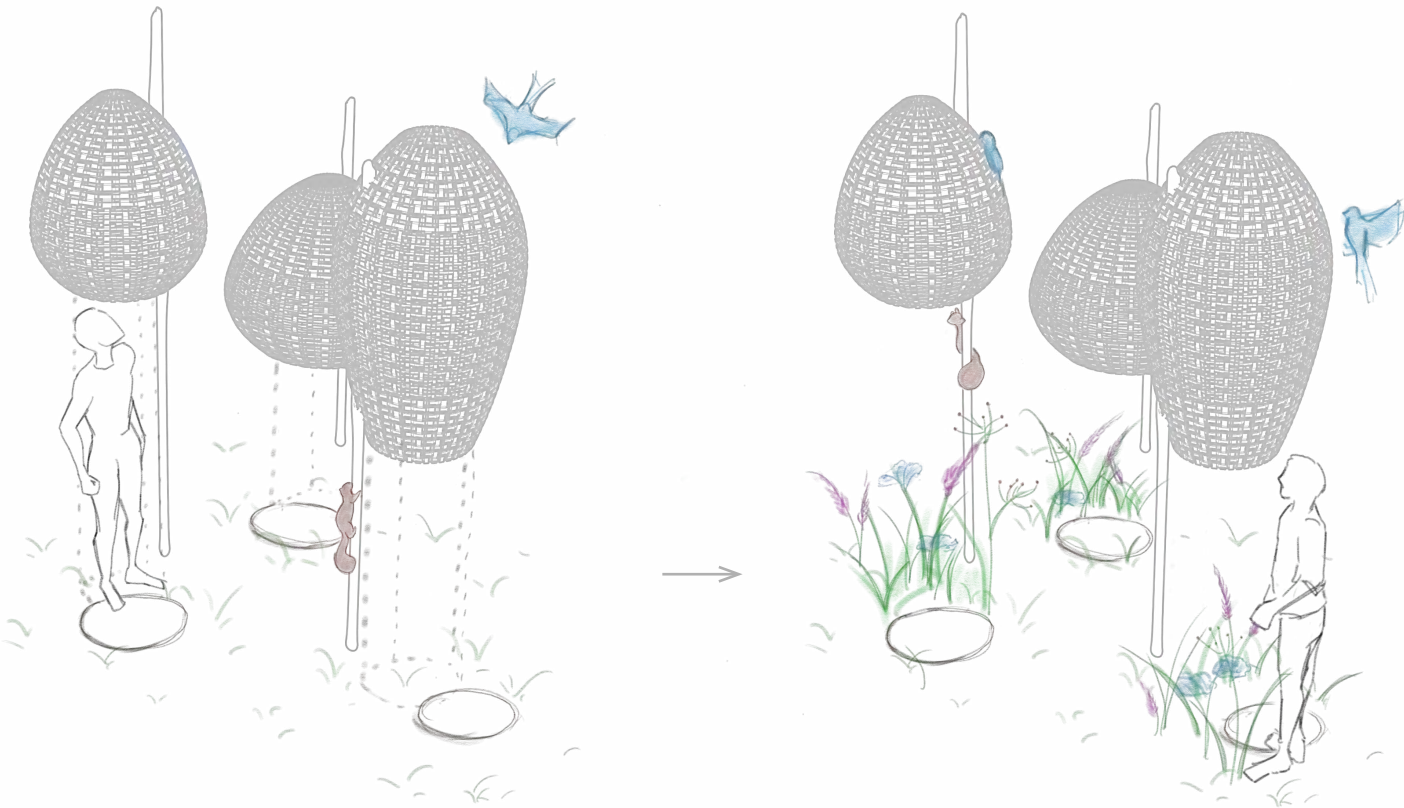



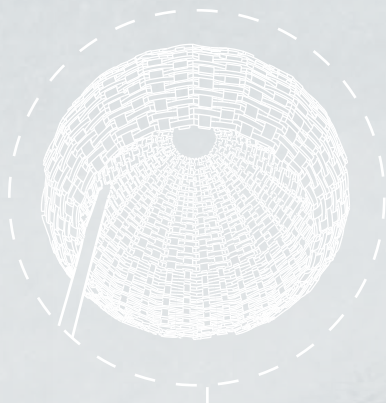

WEAVING TECHNIQUES :

PLAITING

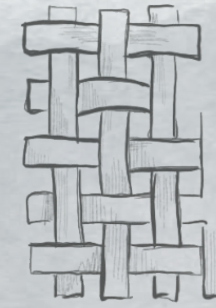

WICKER

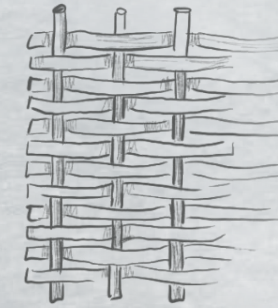

TWINING

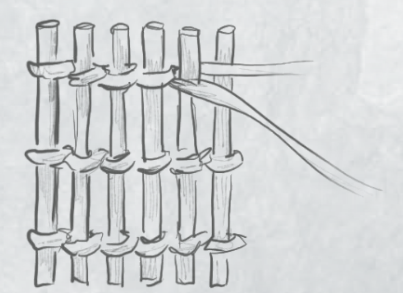

SEED INSTALLATION :

