

the play

Our concept focuses on employing innovative soil aeration techniques to bolster plant resilience amidst shifting environmental dynamics. Concealed beneath the surface, a subterranean network of pipes, linked to ground-level air outlets, orchestrates soil aeration—a sustainable process powered by air circulation facilitated through pumps.

At the epicenter of our installation resides the 'Actor,' an integrated convergence of pipes, plants, and dynamic elements. This centralized construct transforms into a live, responsive theater, dynamically engaging with human interaction.

Engagement initiates as visitors encounter discreet triggers nestled within entrances and seating areas, inciting the 'Actor' to unveil diverse sensory encounters—balloons, primal sounds, and fragrant plant aromas dispersed through propellers. Each interaction and seated moment prompts a chain reaction, creating an intricate interplay between audience engagement and the installation's interactive nature.

Much akin to the ceremonial significance found in Native American totems, this interactive structure beckons observers to immerse themselves. Unfolding a narrative within a captivating and responsive theater of ecological interdependence, it invites exploration into the intricate relationship shared between mankind and the natural world.

envisaged vegetation

Clematis virginiana - Virginia Clematis
Solidago sempervirens - Seaside Goldenrod
Heliopsis helianthoides - False Sunflower



Virginia Clematis



Seaside Goldenrod



False Sunflower

envisaged roles of the actor

Breathing - Inflation and deflection of balloons, windmill
Hugging - Providing habitats for bats, birds, bugs and vegetation
Crying - Moisturizing surroundings and providing drinking water for wildlife
Singing - Sounds made by pipes and the living wildlife

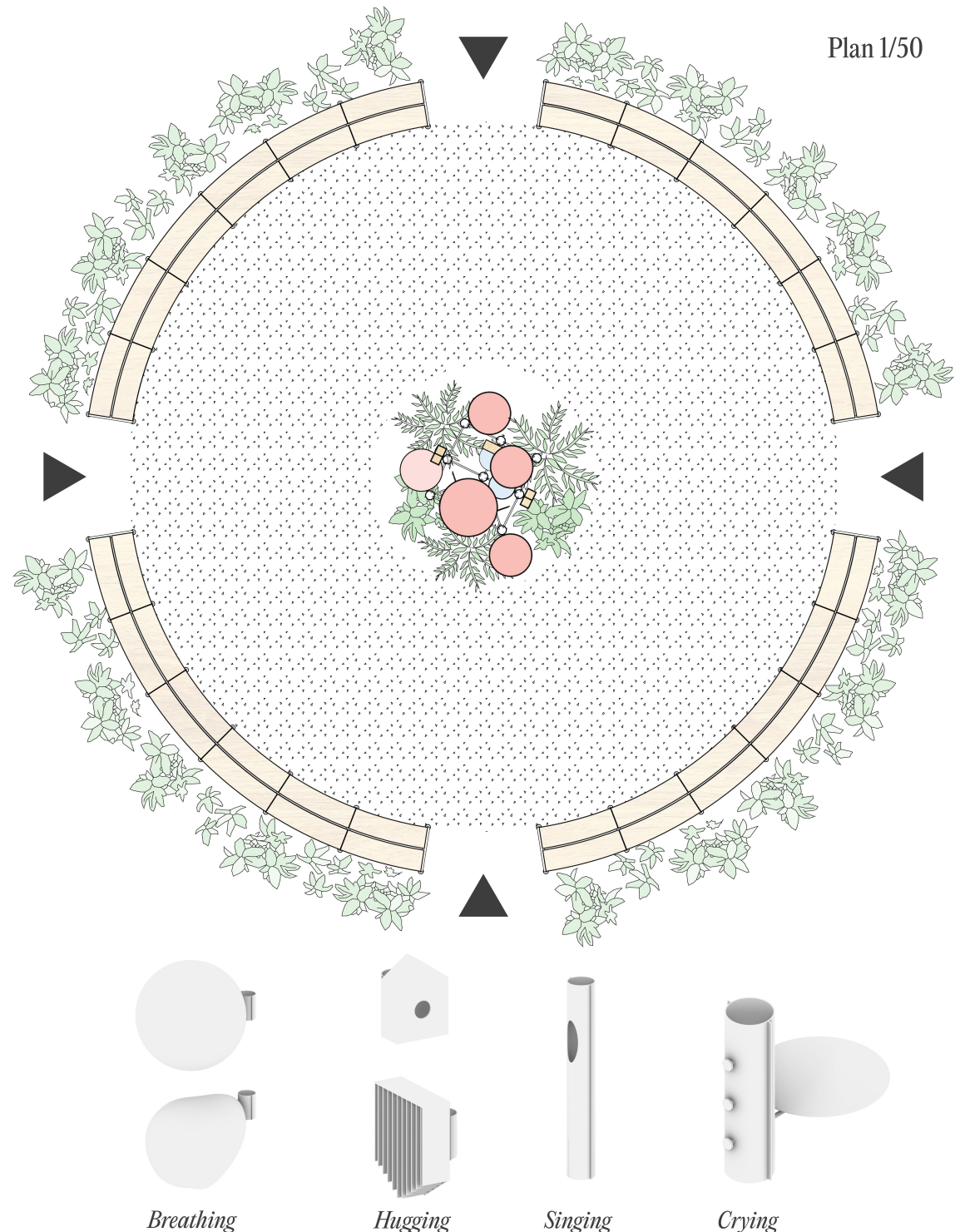

the play

Structure

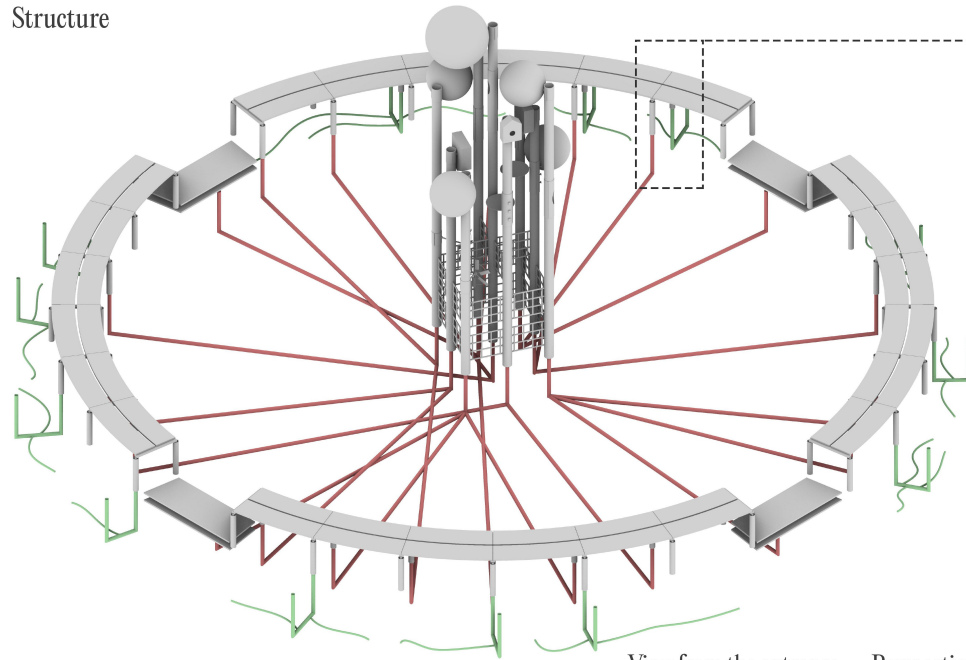

Bicycle Spring/
Pump System

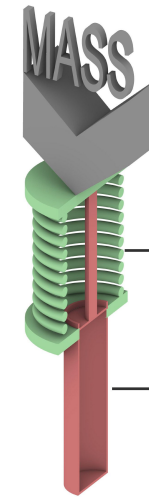
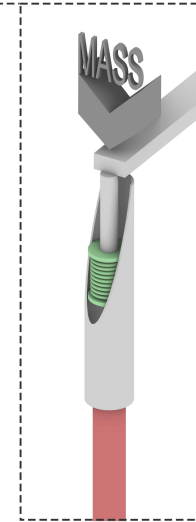

Regular
Bicycle
Spring

Regular
Bicycle
Pump

The interconnected spring and pump system operates in response to spectator movements. The spring facilitates the bench's return to its original position while allowing controlled movement based on mass. Linked to a standard bicycle pump, this system channels air to both the subterranean soil aeration system and the "actor." Although the underground components remain hidden from view, spectators witness a sequence of reactions triggered by their actions—entering, seating, or even moving atop the benches—manifested through the "actor."

The open-ended nature of the soil aerating system ensures the circulation of fresh air specifically to the plants' rhizosphere, sustaining a conducive environment for their growth and vitality.

View from the entrance

Perspective View

