

INSECT VISION

“...if invertebrates were to disappear, I doubt that the human species could last more than a few months.” -E.O. Wilson (1987)

Insect Vision increases empathy between humans and the world’s vanishing insect populations by inviting humans to experience the environment through the eyes of insects.

The centerpiece of the design is a pair of offset, curving parametric benches. Made from extruded aluminum tubes, the benches are wrapped in a high-contrast neon vinyl covering. The color palette is inspired by UltraViolet light photography of *Iris versicolor* (Blue flag iris), the floral emblem of Québec. To human observers, UV photography of plants reveals an approximation of how insects view petals, stamen, pollen, nectar, and other plant parts. Clear, glow-in-the-dark paint is splattered on top of the vinyl covering, creating a glowing effect at dusk and early evening.

The application of these colors lures festival goers through a densely planted grove of *Betula papyrifera* (Paper birch) saplings—much like an insect is attracted to the reproductive organs of a flower.

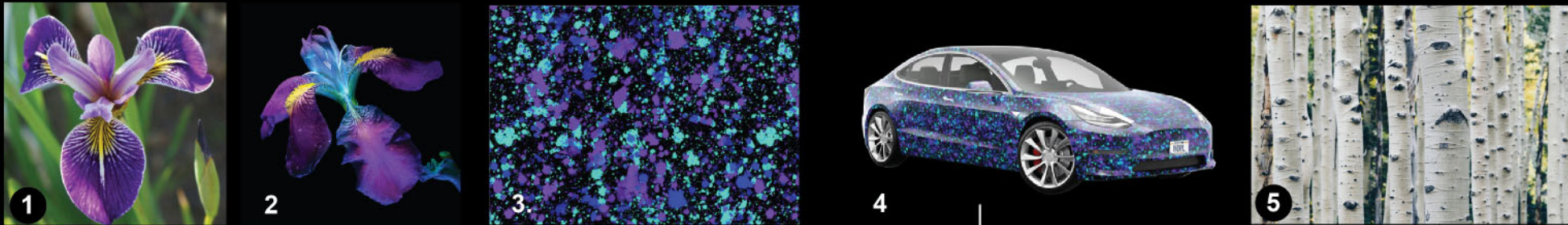

1. *Iris versicolor* (blue flag iris) under normal light conditions
2. *Iris versicolor* (blue flag iris) under UltraViolet (UV) light (© Debora Lombardi, 2022)
3. Rwraps™ Paint Splatter Print Vinyl Wrap Film - Dark Skies
4. Typical use case of Vinyl Wrap Film on sedan
5. *Betula papyrifera* (Paper birch) trunks surround the benches

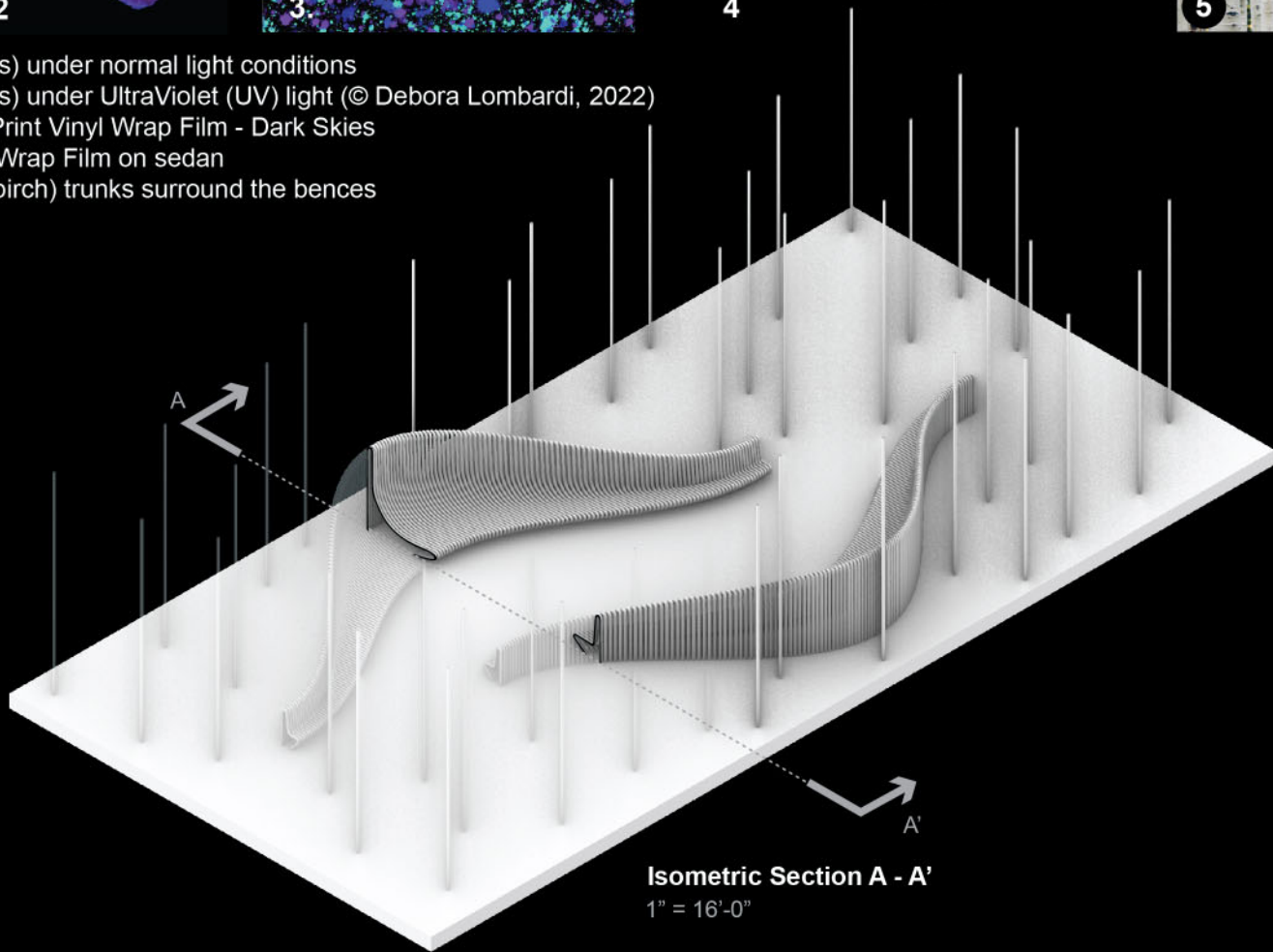

Isometric Section A - A'
1" = 16'-0"

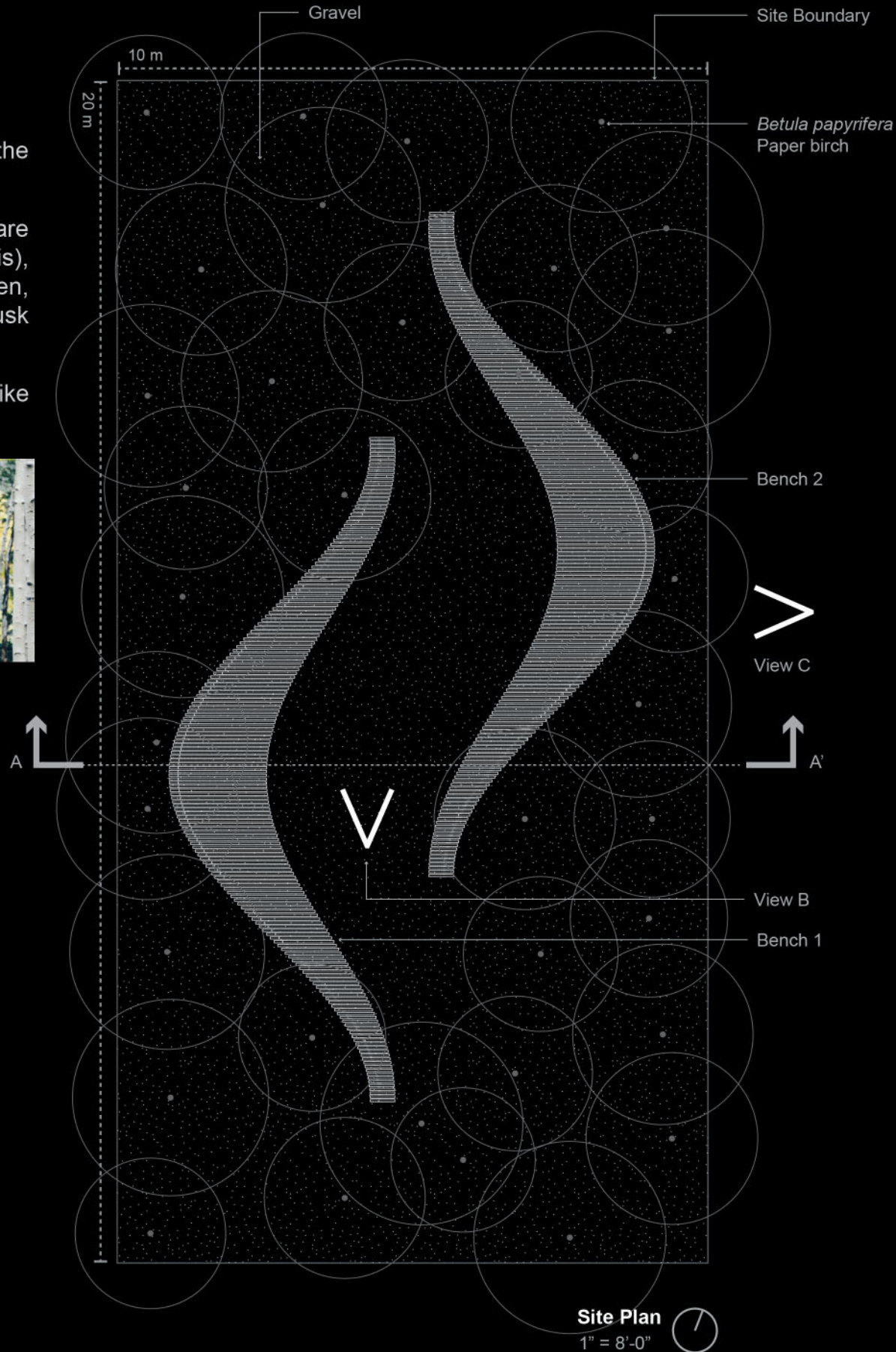

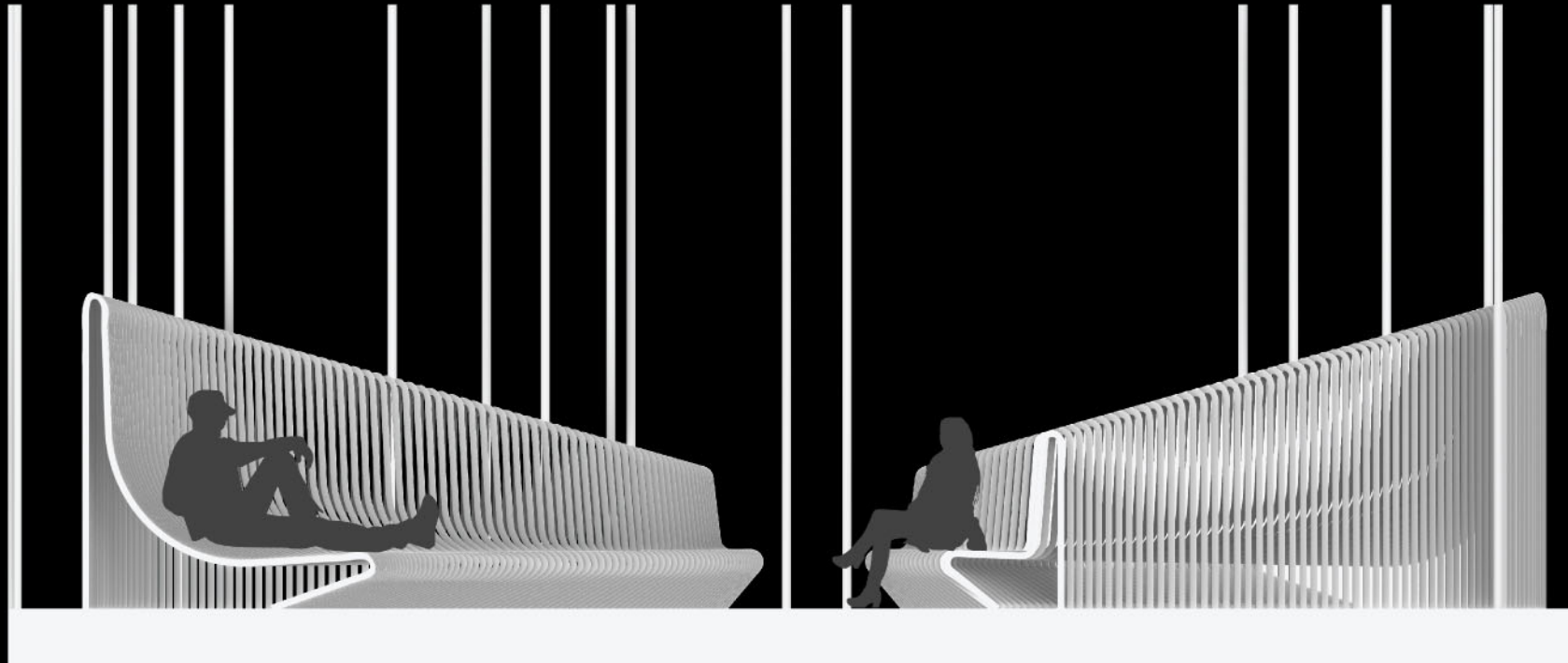

A: Section - Elevation A - A'

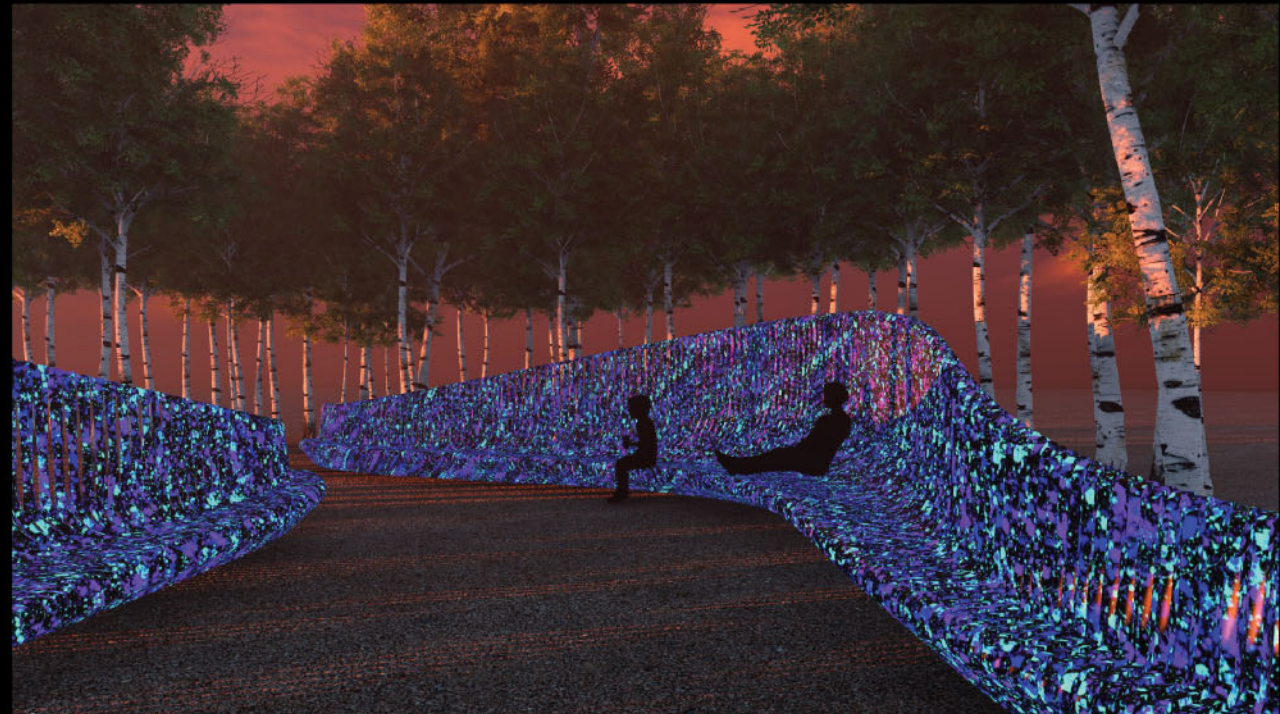

B: Dusk view



C: Elevation view from the east looking west