

the Layout Plan 1 : 40

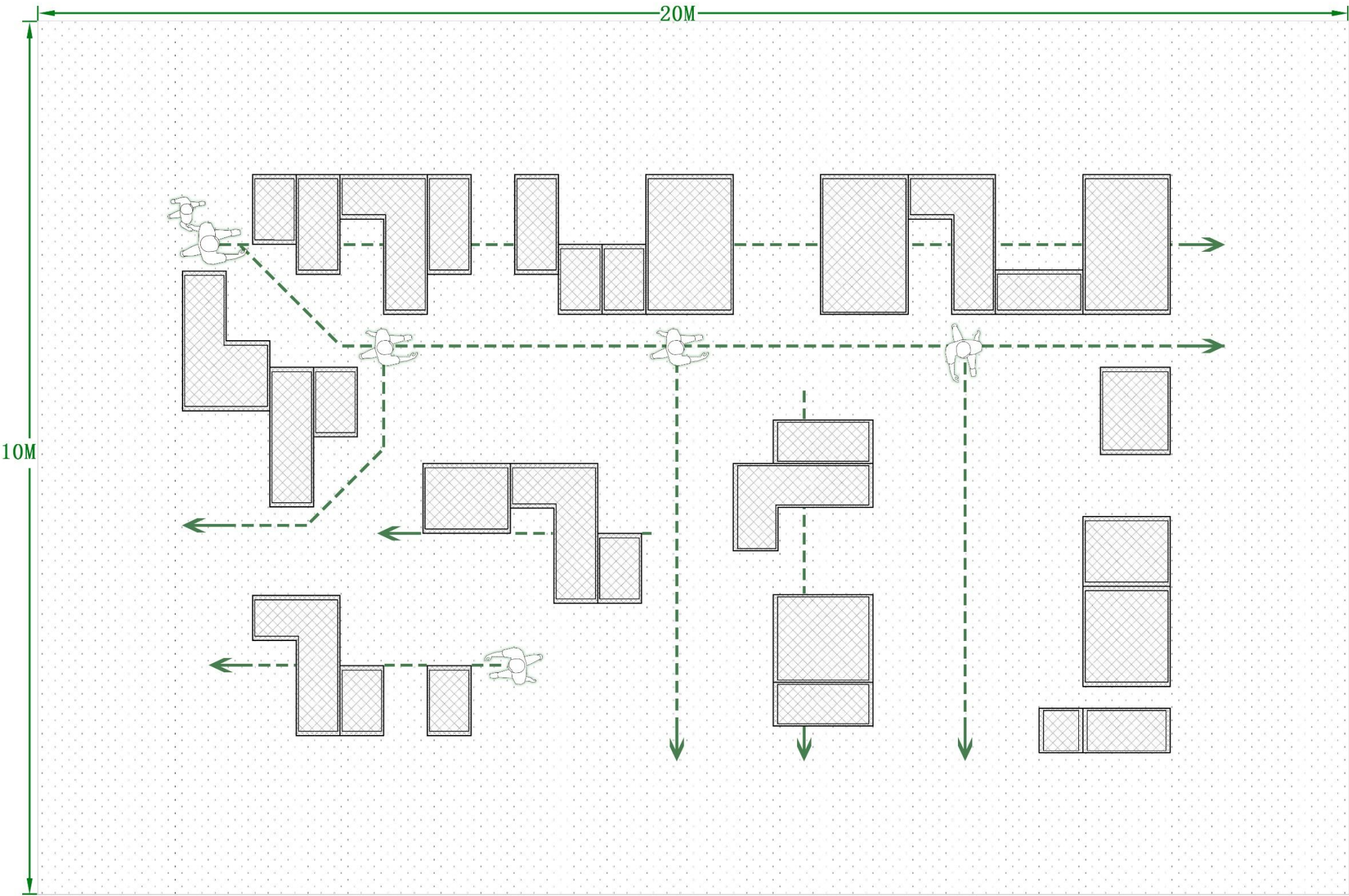

List of Recommended Plants



Rubus chamaemorus L



Linnaea borealis



Dryas integrifolia

Concept Description

Double root

What is the meaning of root?

A root can be an entity, like the soil where plants absorbing nutrients, or a place where people standing. It can also be a kind of emptiness, a shade of interlaced branches and leaves, or the destination of human soul.

The design combines the two: the root and stem of the plant break through the soil to form a space under the root, carrying the nutrients in the soil inside for the root to take root again, so it is called "double root". The first root is a woven outer frame, which can hold soil inside, symbolizing the rhizome for transporting nutrients. It is precisely because the rhizome continuously transports nutrients that plants can branch, and the leaves are luxuriant. It's like the rapid development of science and technology. The second root is the plant cultivated on the soil, which symbolizes the life bred by the root. They can also create a landscape if they take root again in the soil. It is just like embracing the future of the technology express and rebirth.





the Experience of Visitor



Elevation plan

