

Round Mound of Re(bind)

The garden binds three disparate elements - masonry, wood, and earth – to create a new framework for an ecosystem that can adapt to the changing environmental context.

Environmental disruption from climate change has revealed the importance of plant life in sustaining our livelihood and a need to recalibrate what constitutes as ‘nature’ in adapting to the new norm. We must rethink nature, not purely as an antithesis to the built environment, but rather as an open condition deeply rooted in ecological and artificial contexts. Unlike a conventional pavilion where plant life is displayed as an effect, the garden features the interdependence of plant life and the built environment as the architecture weathers into nature.

The garden consists of a horizontal plywood platform, planters made of concrete masonry unit, and an earth mound. These elements work together to structurally hold one another and facilitate the garden’s adaptation from the surrounding context. Over time, the earth mound held by CMU and the plywood platform will take in the vegetation both planted and drawn from the wilderness. The garden is rooted on a slightly excavated ground to allow visitors to sit, walk, and stand in and around the project to observe nature’s work over time.



disparate
conventional

integrated
proposed

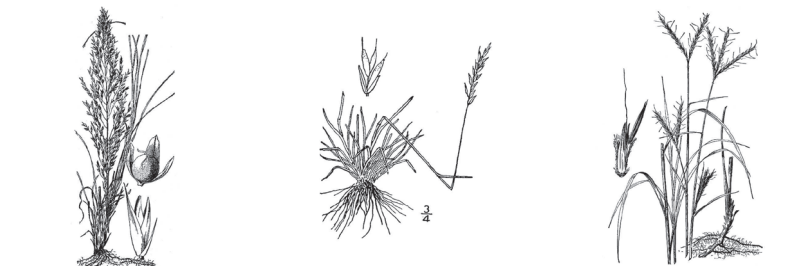

Sporobolus heterolepis Festuca brachyphylla Andropogon gerardii



platform mound planter/column



plywood loam cmu



view of the elevated platform

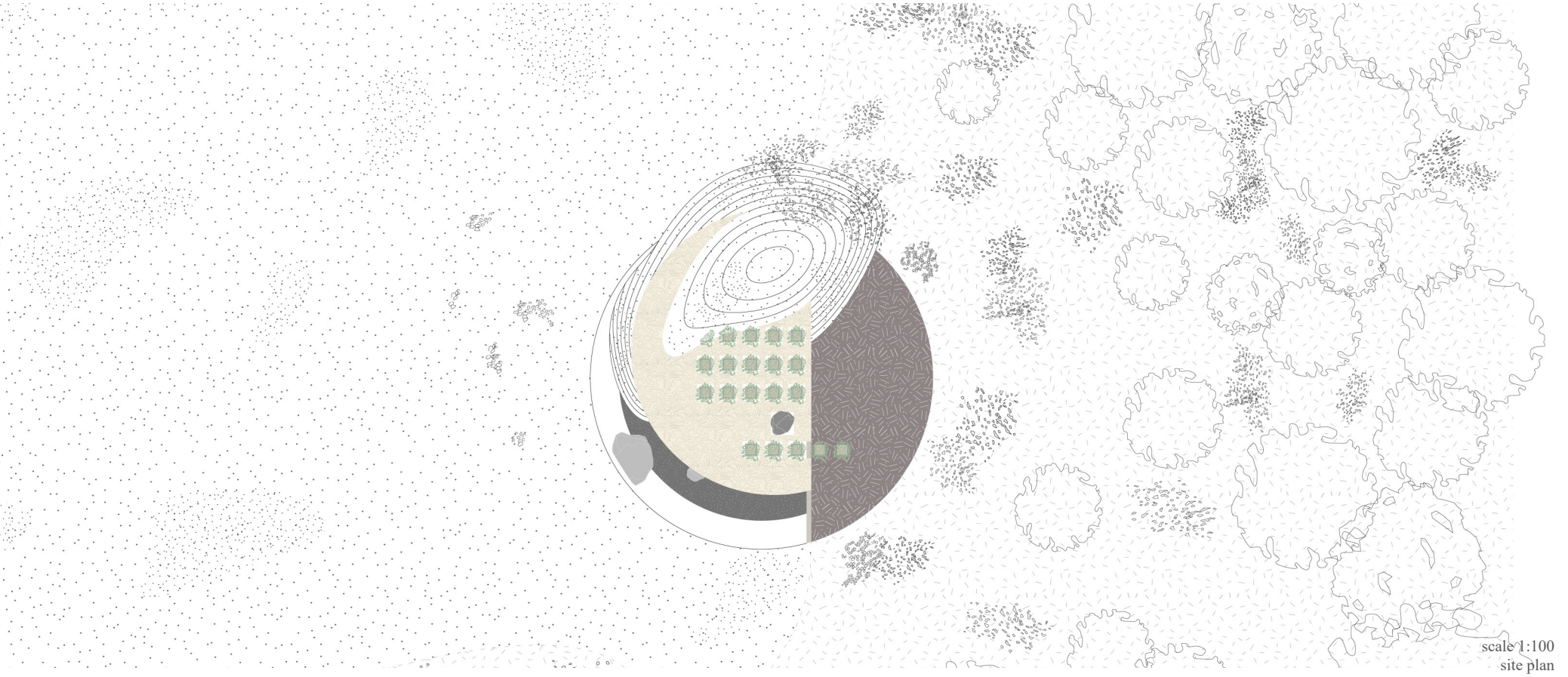

scale 1:100
site plan

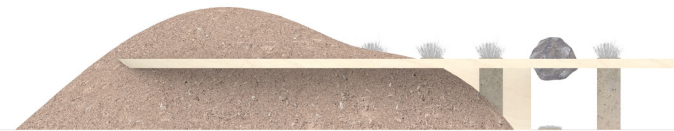
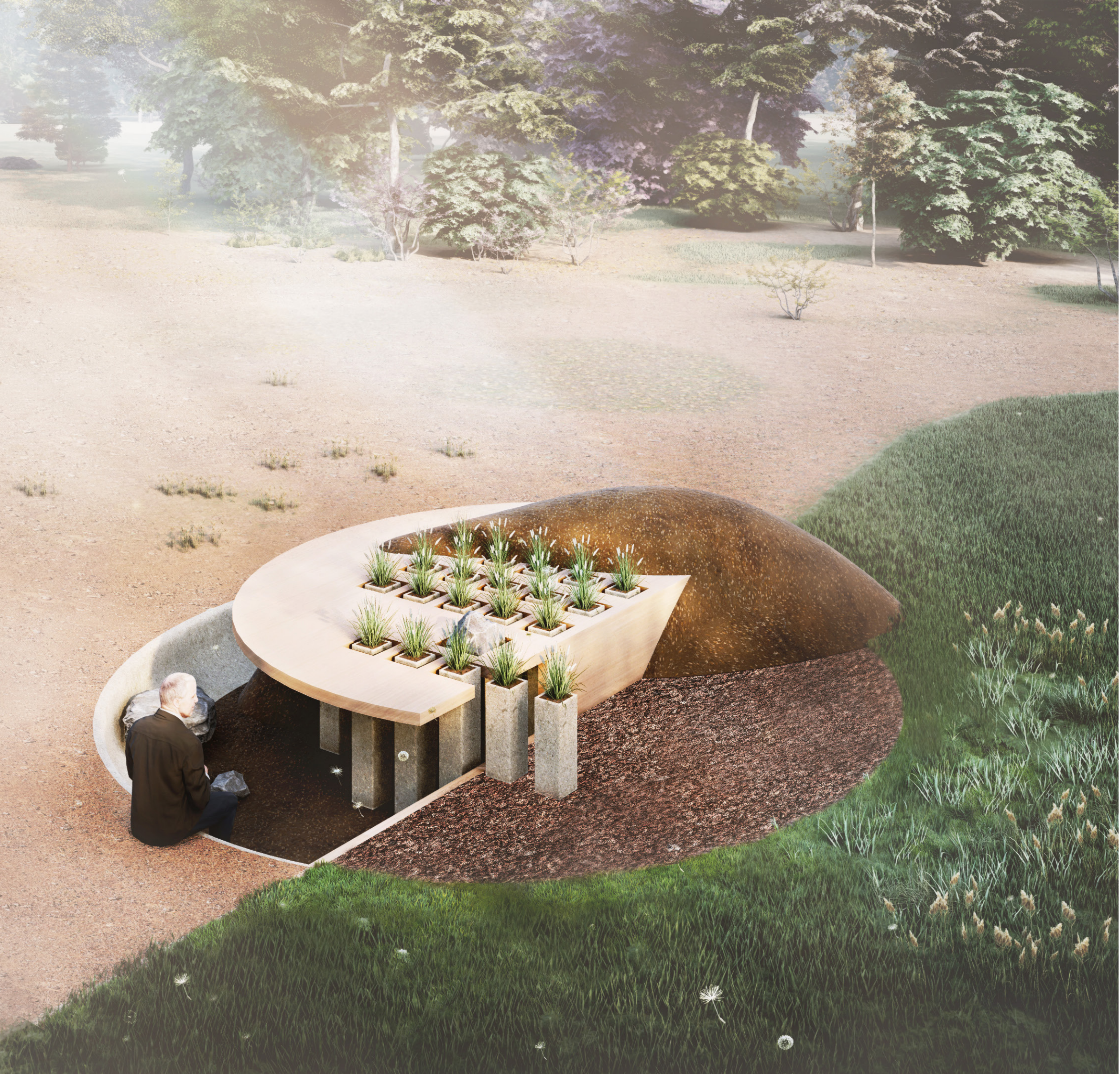

East elevation



North elevation

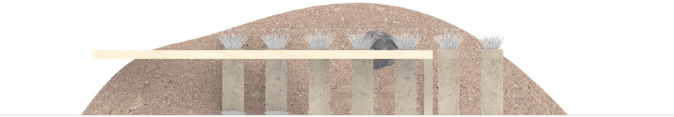

South elevation



view of the three elements binding one another



under the platform