

Tunnel of the present

Selection of proposed species:



Petunia x atkinsiana
for pots



Lobularia maritima



Tagetes tenuifolia



Begonia semperflorens



Phlox drummondii



Nigella damascena



Lagurus ovatus

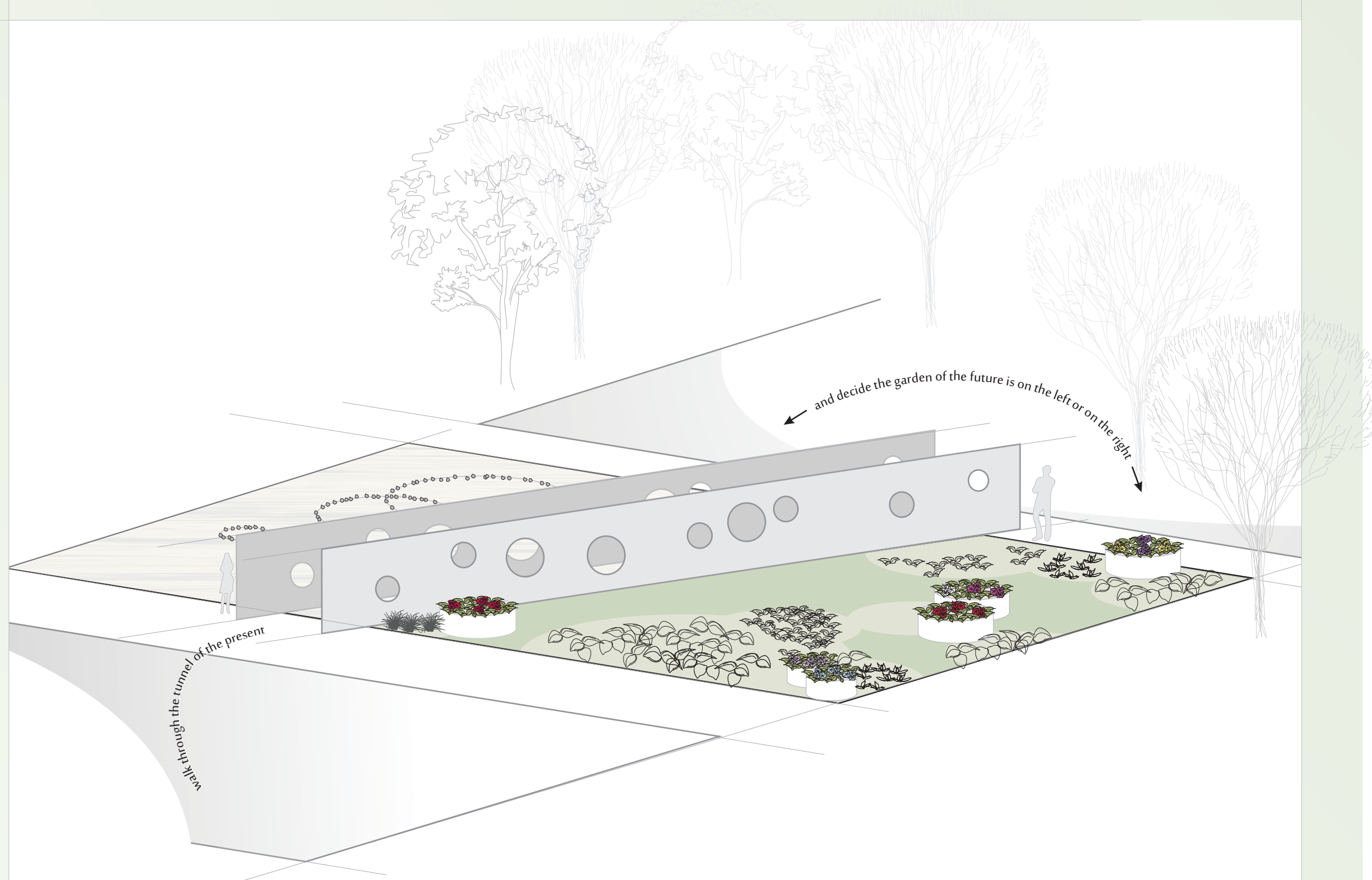

Tunnel of the present

What is a garden? A composition of soil, stones, water and plants, enriched sometimes by other artificial elements. What will happen if one or two elements will disappear e.g. plants? Even in so called “dry gardens”, originated from Japanese zen gardens, usually there is a little of plants. A garden without water and plants is still a garden or an imitation of garden?

How will our gardens look like in the future, if at present more and more lands around the whole globe transform into wastelands and desserts?

Two circle gardens: a green and a dry one. Both have their charm, especially if we have a choice which one we would like to have near our homes. But what if we will have no choice and be doomed to only one possibility, because of environmental pollution, changes in climate, lack of water?

Walking through a tunnel of the present in this garden allows visitors to think how they would like our gardens to look in the future, which version they pick out: a green or dry one? And what they should do in the present for the gardens of the future?

