

# Shifting Grounds

Our concept presents a garden that is in constant transformation, using movable folies to redefine the space and blur traditional boundaries. These folies, act as flexible partitions that open and close, inviting visitors to interact with a space that's always shifting. Unlike rigid borders, these structures create a living, breathing boundary—one that separates and connects, inviting visitors to experience a garden that is neither fully enclosed nor entirely open.

The installation embodies the idea of borders as dynamic passageways rather than barriers. Each folie changes position, offering new perspectives and redefining spaces, encouraging visitors to explore and question the boundaries within the garden. It's a system of communication between humans, nature, and the unknown beyond, sparking reflection on how we define and navigate divisions in our world. As visitors engage with the folies, they experience the garden as a place of continuous negotiation and connection.

## Suggested Plants



Sweetgrass  
(*Hierochloa odorata*)



Red Fescue  
(*Festuca rubra*)



Sheathed Dropseed  
(*Sporobolus vaginiflorus*)

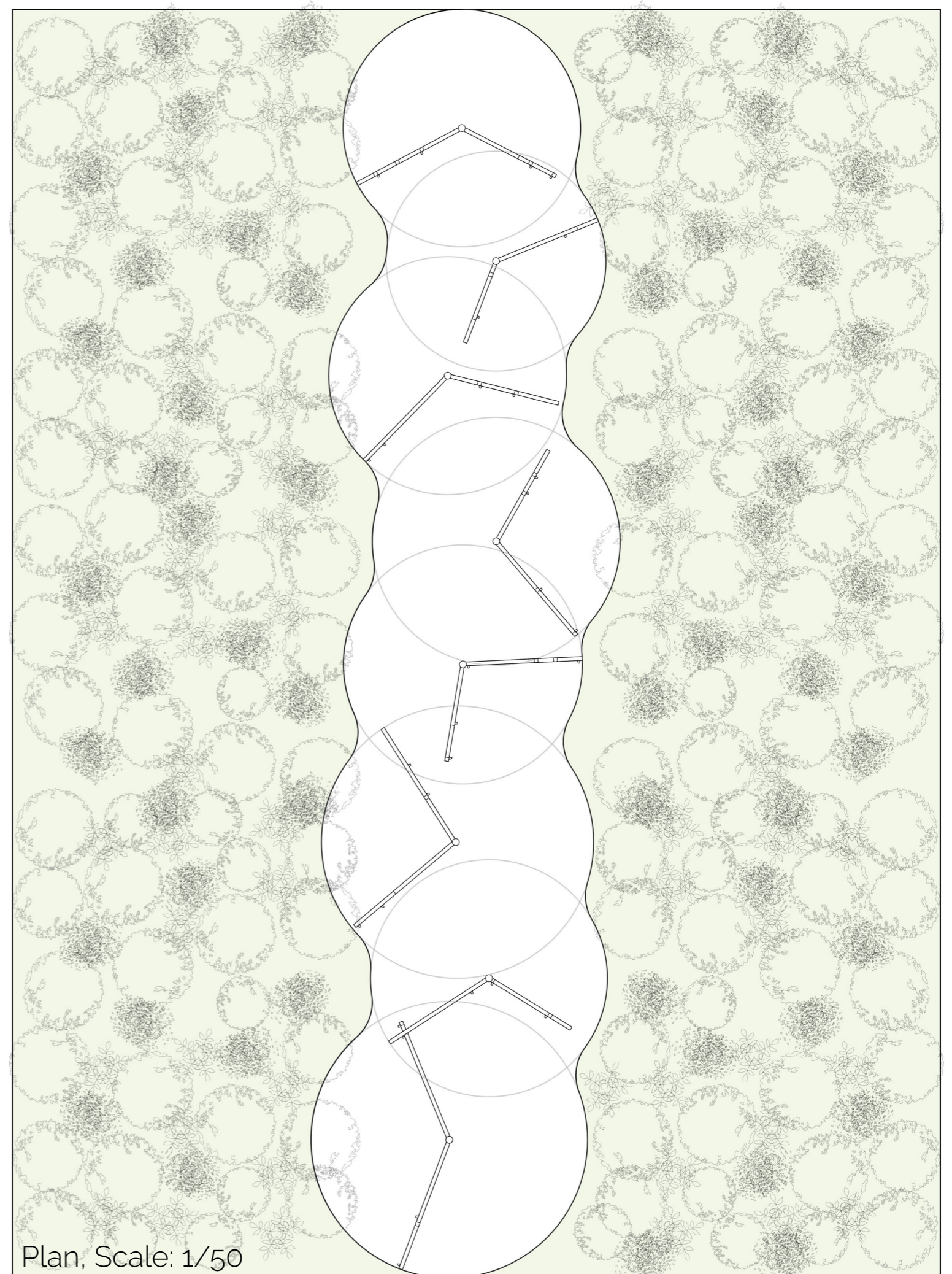

Plan, Scale: 1/50



### Structural System

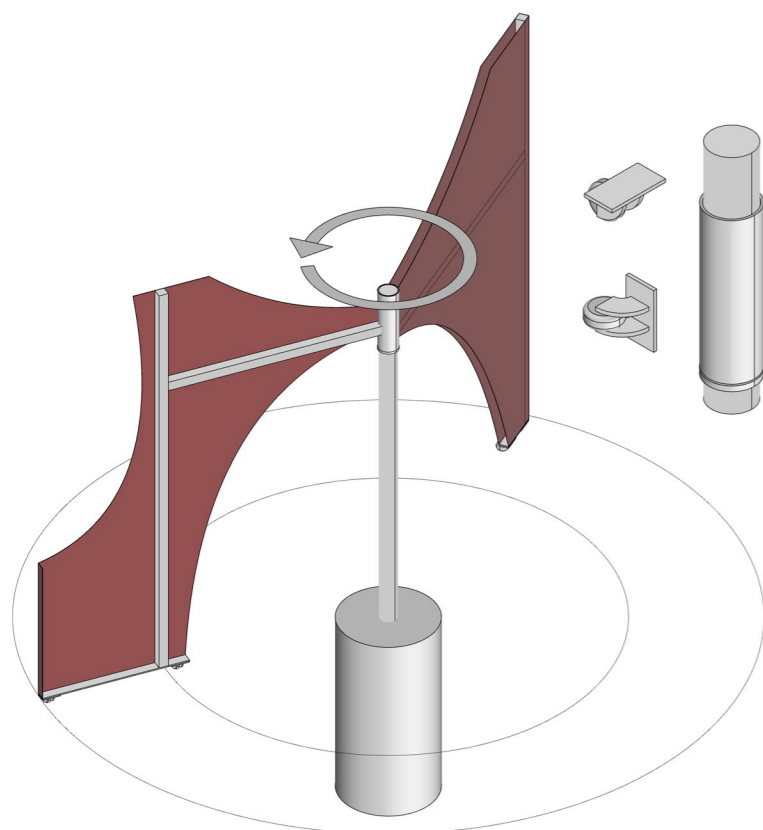

Central pole  
Simple sleeve bearing  
Wheels for ease of rotation

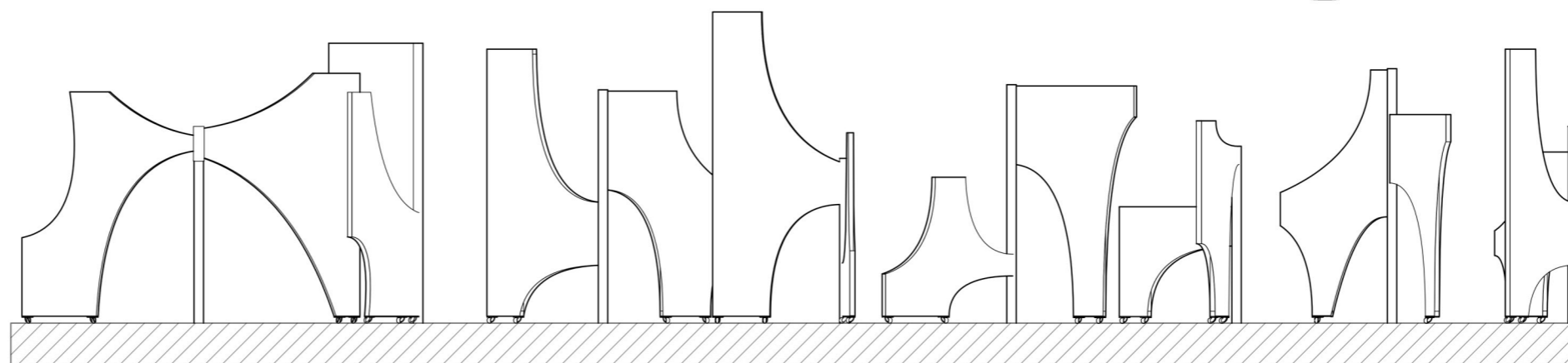
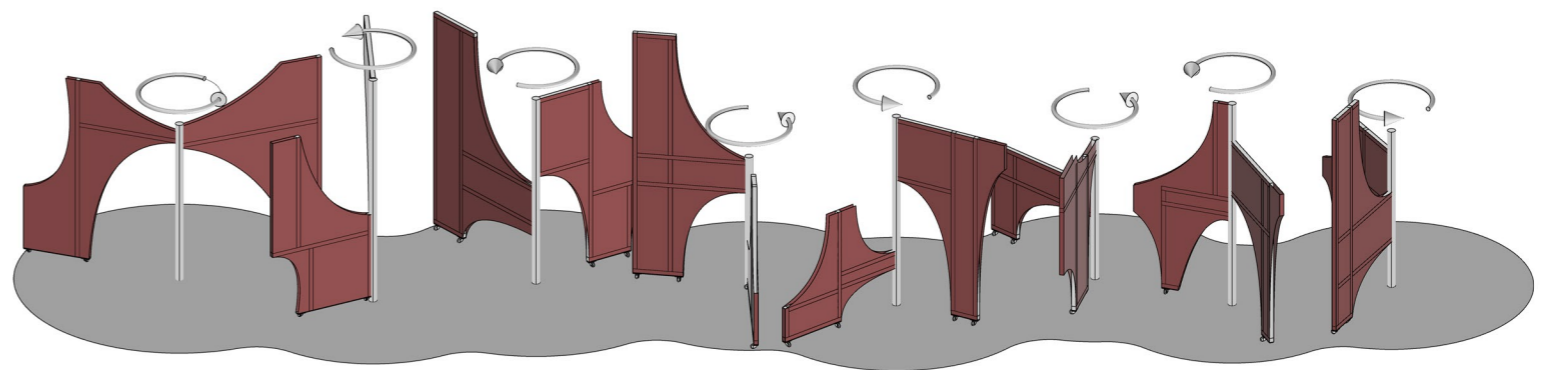

Side View, Scale 1/50

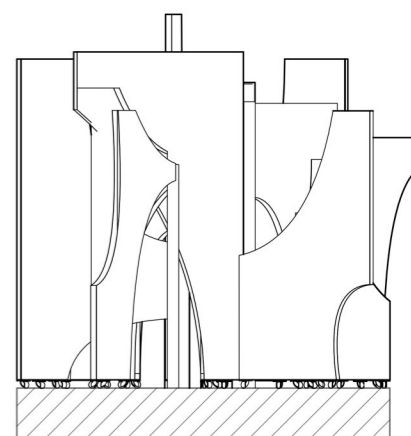

Front, Scale 1/50