

Ephemeral Passage

The installation, a surreal journey through the liminal and the temporal, invites visitors to traverse a space where boundaries dissolve into the fabric of time. A gentle curve leads them along a path that twists, turning 180 degrees, defining an inner and outer realm. Here, the liminal space, a threshold between the seen and unseen, emerges through the intertwining of slender posts, draped with delicate threads that sway like whispers in the breeze. As one moves through, the outer space unfurls, widening with each step, while the inner sanctuary offers serene seating—a place to pause, to contemplate, to reconnect.

Within this quiet heart, native plants bloom, their roots anchored in the earth, yet their tendrils reaching upward, intertwining with the threads. Flowers, bushes, and small trees create a living tapestry, evolving with the passing days, as climbers ascend to join the ethereal dance. This space, fleeting yet profound, beckons the soul to explore the unseen borders within, to embrace the rare encounter where nature and self become one, in a harmony that transcends the physical realm.

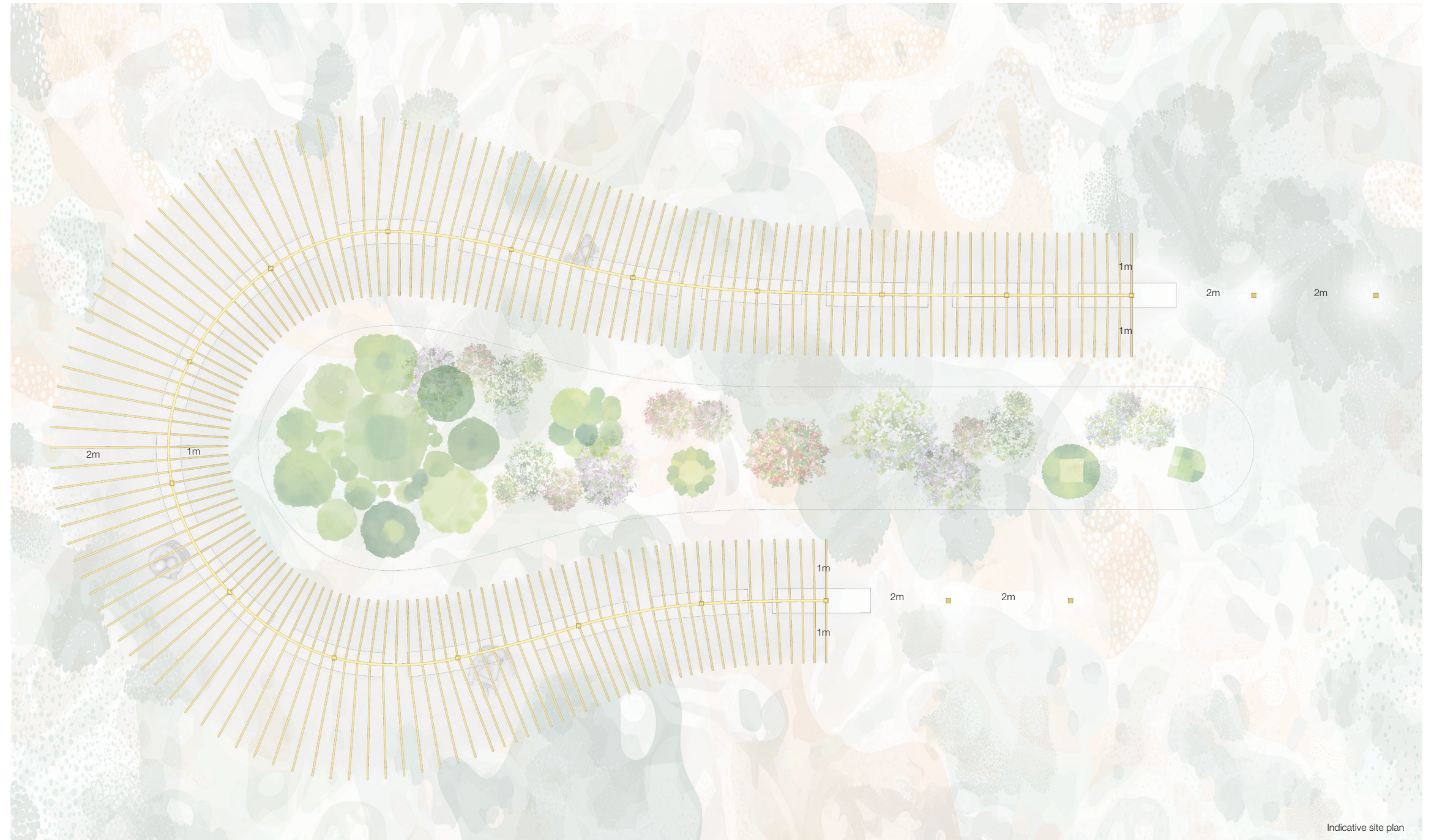

Indicative site plan



Proposed plants - subject to availability and appropriateness. To be coordinated with the local team during the design development phase.

1. Ground Cover

Bunchberry (*Cornus canadensis*): Availability & Suitability: Native to Québec, thrives in cool, moist, and shaded conditions typical of the region. Maintenance: Low, with minimal care required after establishment.

Wild Ginger (*Asarum canadense*): Availability & Suitability: Common in Québec's woodlands, suitable for shady areas. Maintenance: Low, requires little attention once established.

Creeping Juniper (*Juniperus horizontalis*): Availability & Suitability: Native and widely available in the region, suitable for sunny, well-drained areas. Maintenance: Low, drought-tolerant, and requires minimal care.

2. Perennials

Columbine (*Aquilegia canadensis*): Availability & Suitability: Native to Québec, thrives in well-drained soil and partial shade. Maintenance: Low, self-seeding, and easy to maintain.

Solomon's Seal (*Polygonatum biflorum*): Availability & Suitability: Common in Québec's forests, prefers

shaded, moist areas. Maintenance: Low, resilient once established, minimal maintenance.

Black-eyed Susan (*Rudbeckia hirta*): Availability & Suitability: Native and commonly grown in Québec, tolerates full sun to partial shade. Maintenance: Low, drought-resistant, and easy to grow.

Canada Anemone (*Anemone canadensis*): Availability & Suitability: Native to the region, prefers moist soil and partial shade. Maintenance: Low, spreads easily and requires little upkeep.

Purple Coneflower (*Echinacea purpurea*):

Availability & Suitability: Though not native to Québec, it is widely grown and adapts well to the region's climate. Maintenance: Low, drought-tolerant, and attracts pollinators.

3. Shrubs

Serviceberry (*Amelanchier canadensis*): Availability & Suitability: Native and widely available, thrives in a variety of soil conditions. Maintenance: Low, requires minimal pruning and care.

Red Osier Dogwood (*Cornus sericea*): Availability & Suitability: Native to the region, adapts well to wet soils and colder climates. Maintenance: Low, with bright

winter stems requiring minimal pruning.

Mountain Laurel (*Kalmia latifolia*): Availability & Suitability: Though more common in southern regions, it can survive in Québec's climate in sheltered, acidic soil conditions. Maintenance: Moderate, may require some care, especially in harsher winters.

Highbush Blueberry (*Vaccinium corymbosum*): Availability & Suitability: Native and well-suited to Québec's acidic soils and climate. Maintenance: Low, with periodic pruning needed for fruit production.

4. Small Trees

Paper Birch (*Betula papyrifera*): Availability & Suitability: Native and abundant in Québec, well-suited to the local climate. Maintenance: Low, thrives in well-drained soil and full sun.

Eastern Redbud (*Cercis canadensis*): Availability & Suitability: Marginally hardy in zone 4b, requires a sheltered location. Maintenance: Moderate, may need protection in extreme winter conditions.

American Hornbeam (*Carpinus caroliniana*): Availability & Suitability: Native and suited to the local climate, tolerates a range of soil conditions.

Maintenance: Low, slow-growing and requires minimal care.

Sugar Maple (*Acer saccharum*): Availability & Suitability: Native and iconic in Québec, thrives in the regional climate. Maintenance: Low, with beautiful fall foliage and minimal care needed.

5. Climbing Plants

Virginia Creeper (*Parthenocissus quinquefolia*): Availability & Suitability: Native and readily available, hardy and adaptable to different conditions. Maintenance: Low, vigorous grower with minimal upkeep required.

Climbing Hydrangea (*Hydrangea*

anomala subsp. *petiolaris*): Availability & Suitability: Suitable for the region, thrives in shade and partial sun. Maintenance: Low, slow to establish but requires minimal care afterward.

American Bittersweet (*Celastrus scandens*): Availability & Suitability: Native and suited to the region, with vibrant berries adding seasonal interest. Maintenance: Low, but requires careful management to avoid becoming invasive.

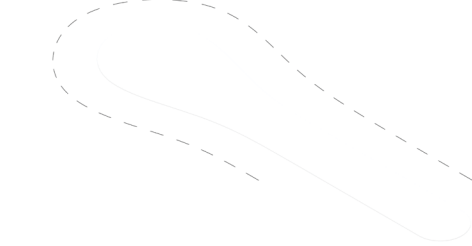
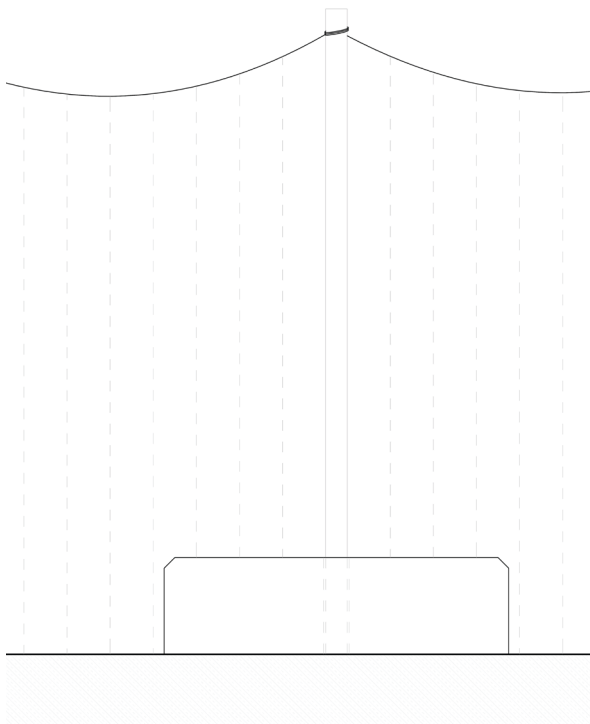
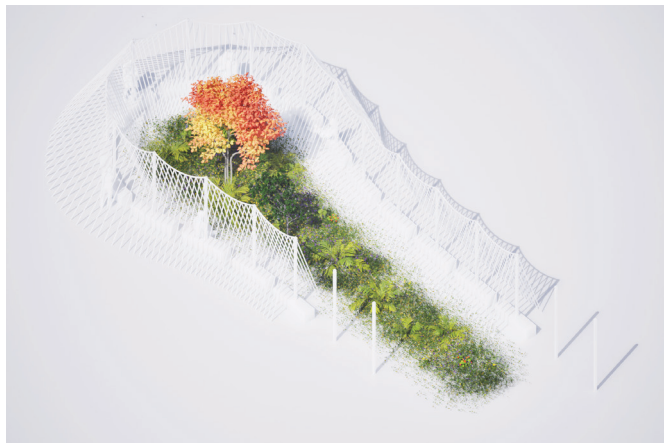

A vaguely temporal liminal space encountered by the wandering souls

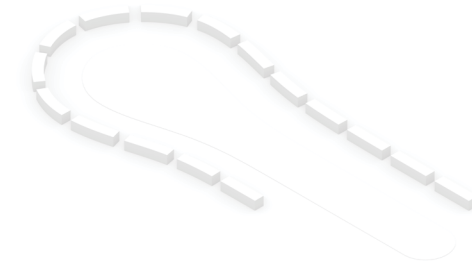

The installation anchored by dashed-line seatings forming the base and defining the foundation of the space

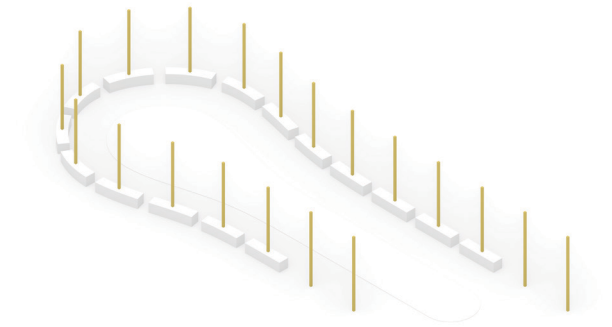

Timber posts inserted into the seats and open ground extending from the border of the liminal space

Indicative detail: off the shelf concrete block seat as foundation on the ground for nom. 100x100mm timber posts with ropes tied to the top for array of thinner threads to be fixed onto

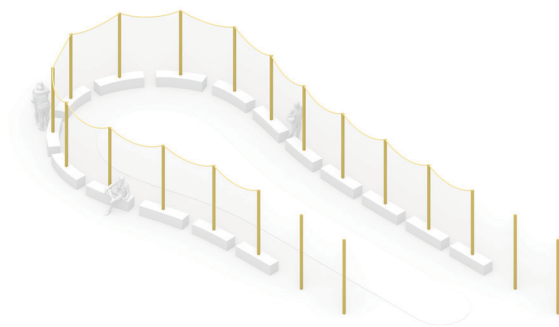

Ropes connecting the top of the timber posts as draping lines - drawing the border

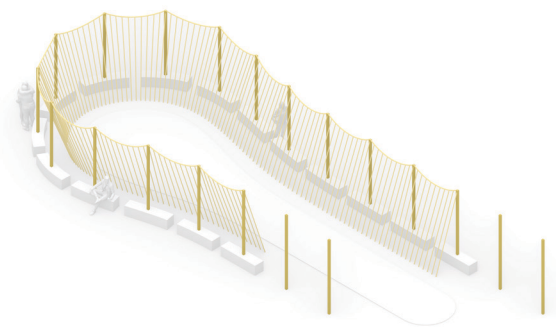

The inner side of the border displayed by arrays of thin threads, revealing the narrower 3-D liminal space

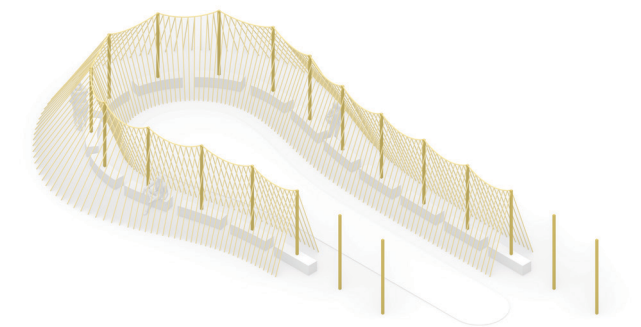

The outer side of the border breathes in and out from both ends of the borders to the belly of the turn - revealing the complete temporal 3-D liminal space

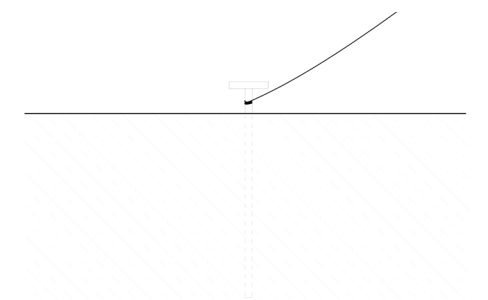

Indicative ground fixing detail: threads into the ground with thin threads tied onto

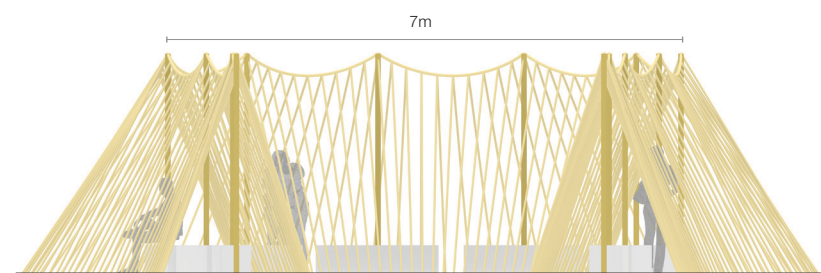

Front elevation

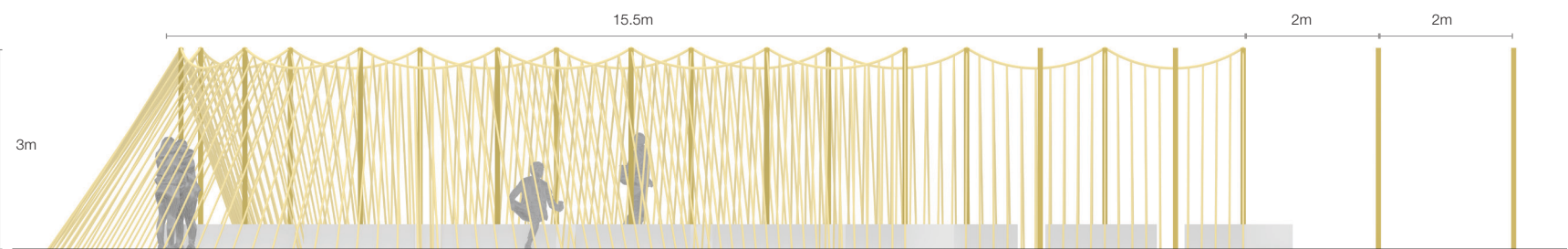

Side elevation