

The Stitch

In 2024, as in every year preceding, borders have been places of tremendous loss and destruction as well as places of hope, resistance, and repair. *The Stitch* offers an immersive, contemplative space which prompts visitors to reflect on the processes of division, destruction, and recovery unfolding in borderlands across the globe today, whether in Ukraine, Palestine, or the southern United States.

The garden consists of a flat plane of decomposed granite split down the center by a dark seam of charcoal, stitched back together at three points by laminated wood bridges, evoking the butterfly joints used to mend fissured slabs of wood. Concrete fragments mounded up on either side of the seam recall the physical destruction and displacement often thrust upon borderlands, while a dense grove of early-successional gray birch trees speaks to the inherent potential of these disturbed sites to heal over time and gradually support life once again.

The Stitch captures the material character of places left fractured in the wake of border conflict, and ultimately gestures towards a future where the rifts carved through these places have been mended through decisive acts of care and repair.



DESIGN INSPIRATION

The plan of the garden takes inspiration from traditional mending practices in which joints and repairs are visually distinct and celebrated: the Japanese ceramic art of *kintsugi* and the butterfly keys of wood craftsmanship.

GARDEN PLAN

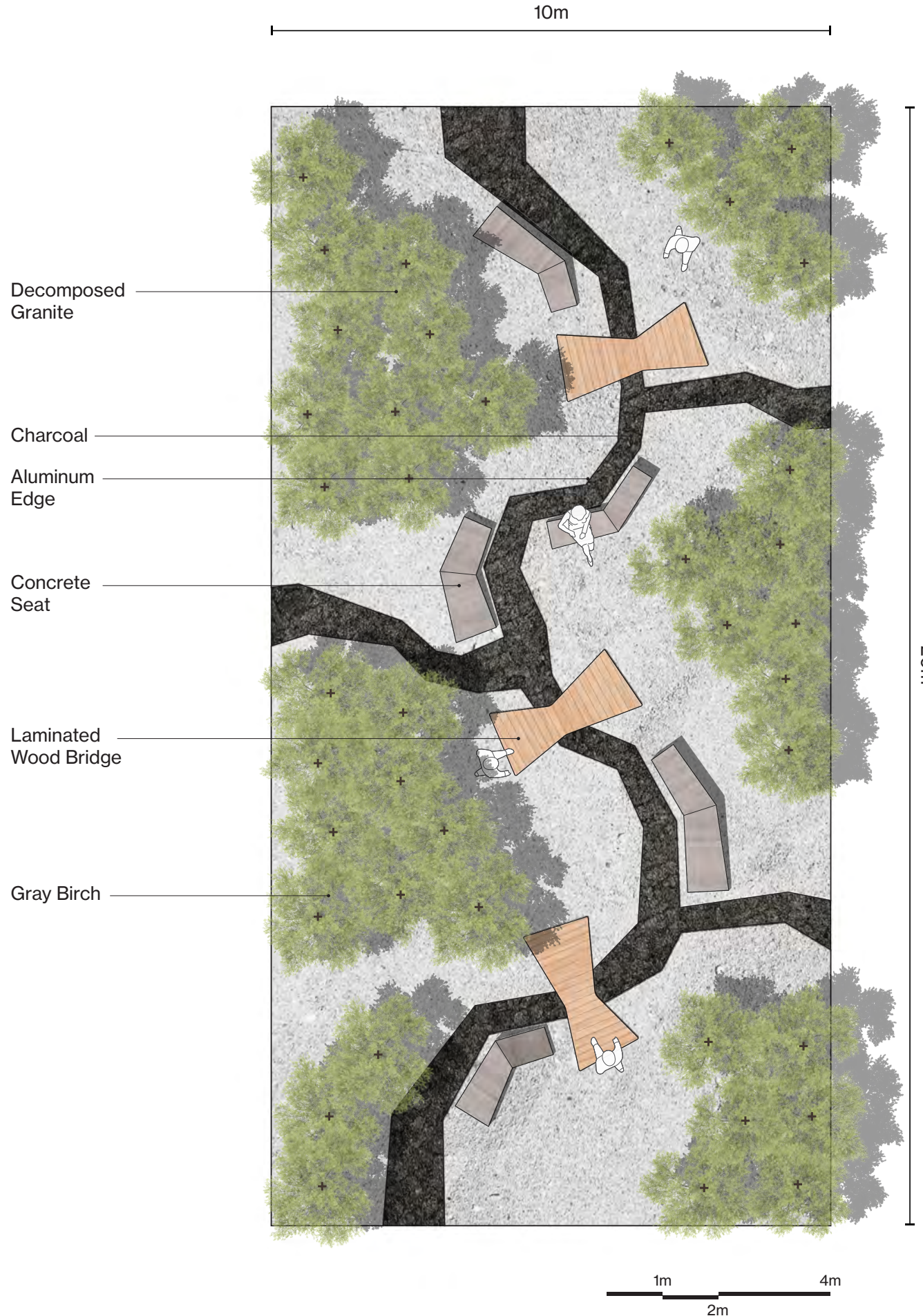

MATERIAL PALETTE + PLANT SPECIES

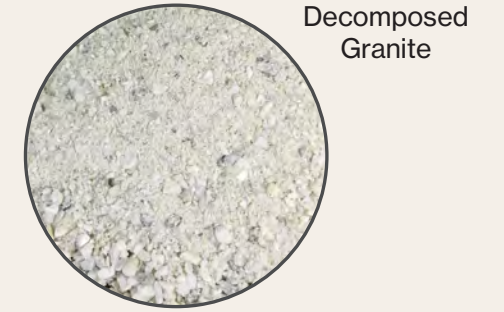

GARDEN AERIAL

The materials used throughout the garden – wood, stone, concrete, and charcoal, and living gray birch trees – are minimally processed and could easily be repurposed in other garden settings at the close of the installation.



Textured concrete fragments provide varied seating opportunities beneath the grove of birch trees.



Laminated wood bridges provide three moments of crossing over the charcoal seam.