

Description

As if life isn't restrictive enough, enter bureaucracy—the artificial, self-imposed, abstract borders of an administrative civilization. *Form Fitting* offers a passageway to the audience that is narrow and not designed for human comfort. Just like the regulatory paperwork it is inspired by, the viewer must contort themselves to meet impermissible boundaries in order to pass. The approach is flanked by fastigate flowering in blue and red, forms and colors that are meant to evoke the pen-and-ink stationery of paperwork. The bordering flowers lead to the folly itself—a pair of tall, curved “sheets” narrowing together towards the center to an uncomfortable, claustrophobic choke point. The sheets are “perforated” with square cutouts that mimic the monotonous boxes of the typical institutional document. The cutouts shrink and disappear altogether as they approach the narrowest point, amplifying the claustrophobic experience. *Form Fitting* is a commentary on the restrictive nature of bureaucracy: a conceptual border that is rigid and indifferent to our needs. A border that stands in inflexible opposition and offers no alternative but to struggle your way through.

FORM
FITTING
FITTING
FITTING

Planting Palette



Bigleaf Lupin (Red and blue)
Lupinus polyphyllus



Switch grass
Panicum virgatum 'Northwind'



Grape Hyacinth
Muscari latifolium



Indian Paintbrush
Castilleja coccinea

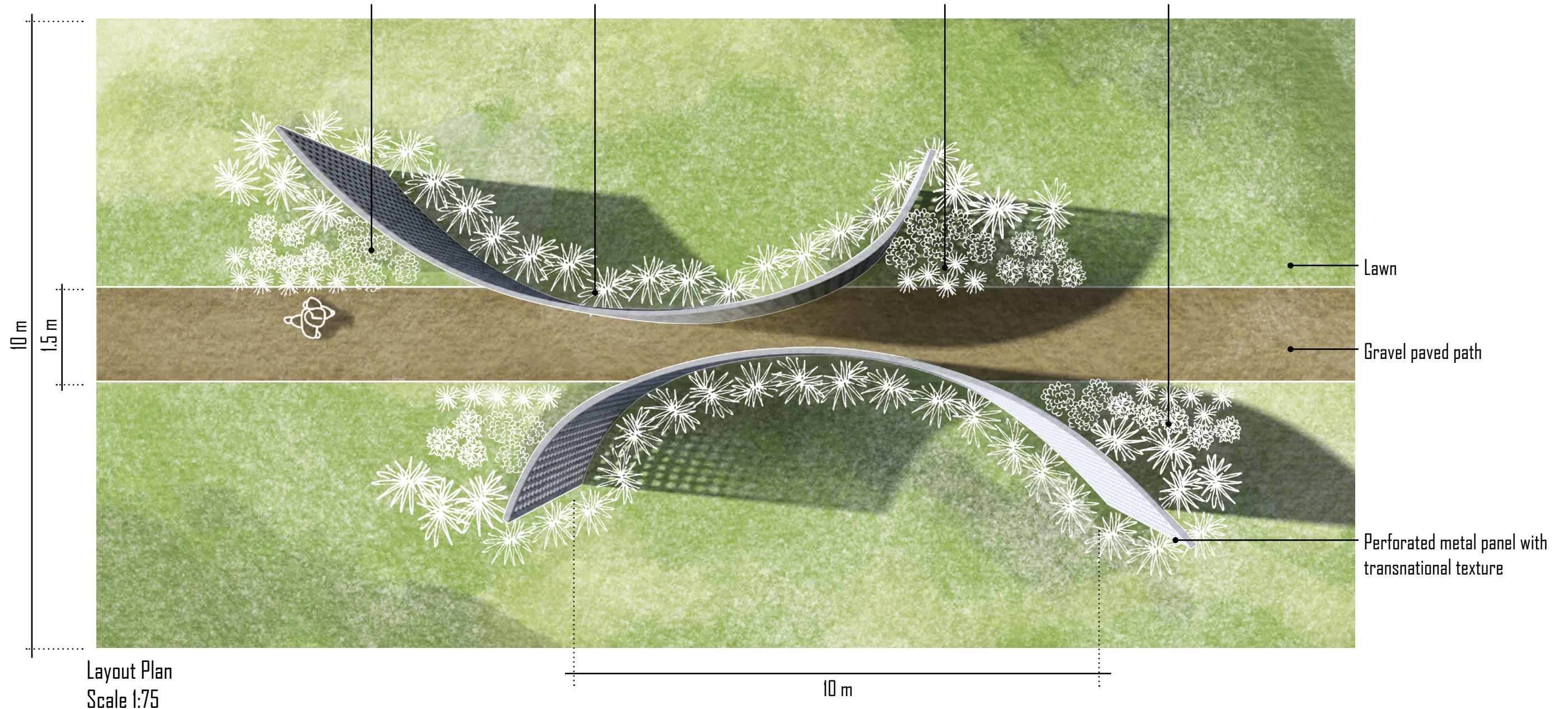

FORM
FITTING
FORM
FITTING
FORM
FITTING

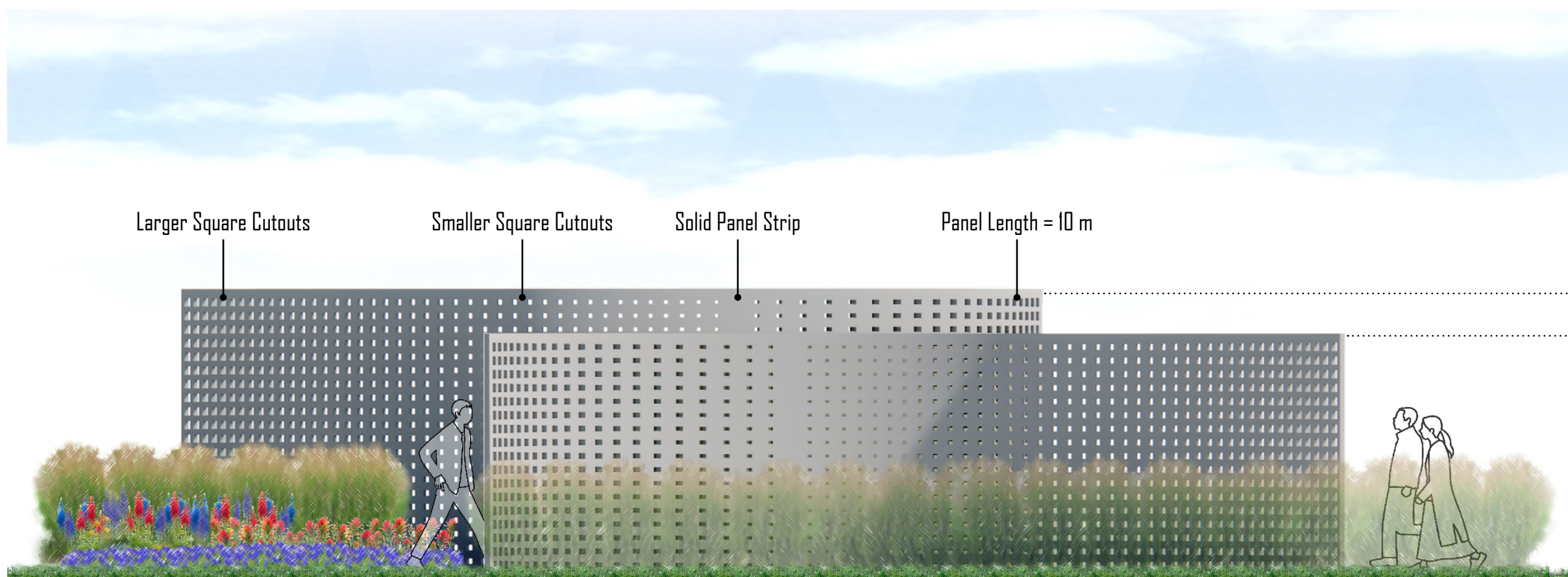

3.0 m
2.5 m

Section Plan
Scale 1:75

