

# Chemin Clôture - Un paysage divisé

*Chemin Clôture* transforms the familiar form of the industrial chain link fence, inviting visitors to experience an unexpected middle ground that redefines the boundaries of the garden. Traditionally a construct for division, the fence here is reimagined, subverting its utilitarian, galvanized steel structure into a permeable, experiential space. Rather than a garden defined by edges, the edges become the garden itself, inviting guests to walk *within* the boundary.

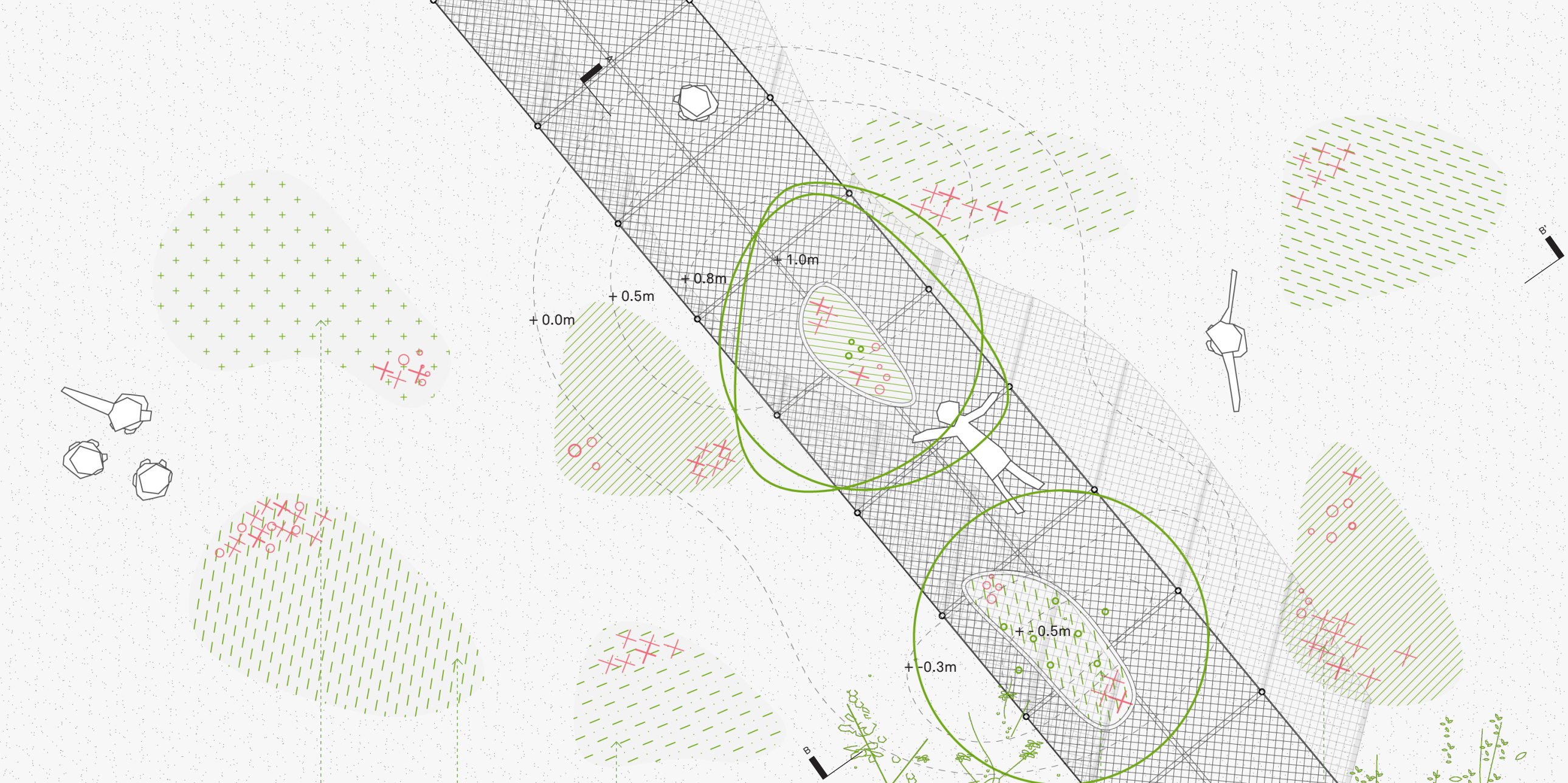

-  **decomposed granite**
-  **planting bed type a:**  
*solidago canadensis*  
*andropogon gerardii*  
*nepeta x faassenii*
-  **planting bed type b:**  
*verbena bonariensis*  
*stipa tenuissima*  
*penstemon digitalis*
-  **planting bed type c:**  
*gaura lindheimeri*  
*sanguisorba officinalis*  
*phlox subulata*
-  **planting bed type d:**  
*solidago juncea*  
*omphalodes verna*  
*fragaria virginiana*
-  **expanded steel grating**
-  **chain link fence**
-  **proposed contour**
-  **proposed trees:**  
*amelanchier canadensis*
-  **+ - 0.5m** **proposed elevation**

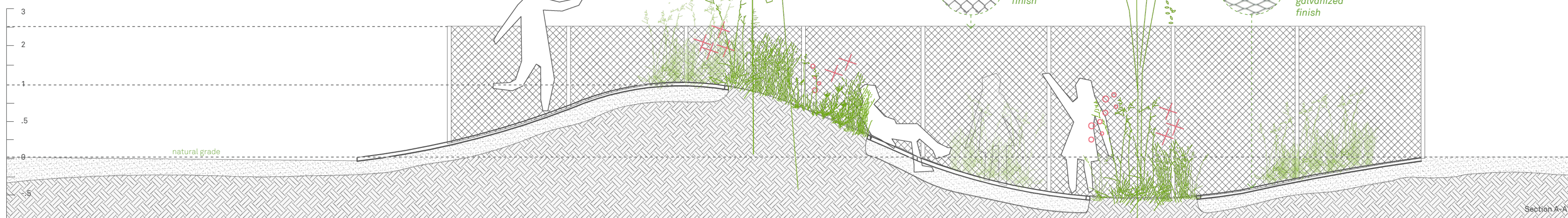

chain link fence, galvanized finish

expanded steel grating above metal framing, galvanized finish

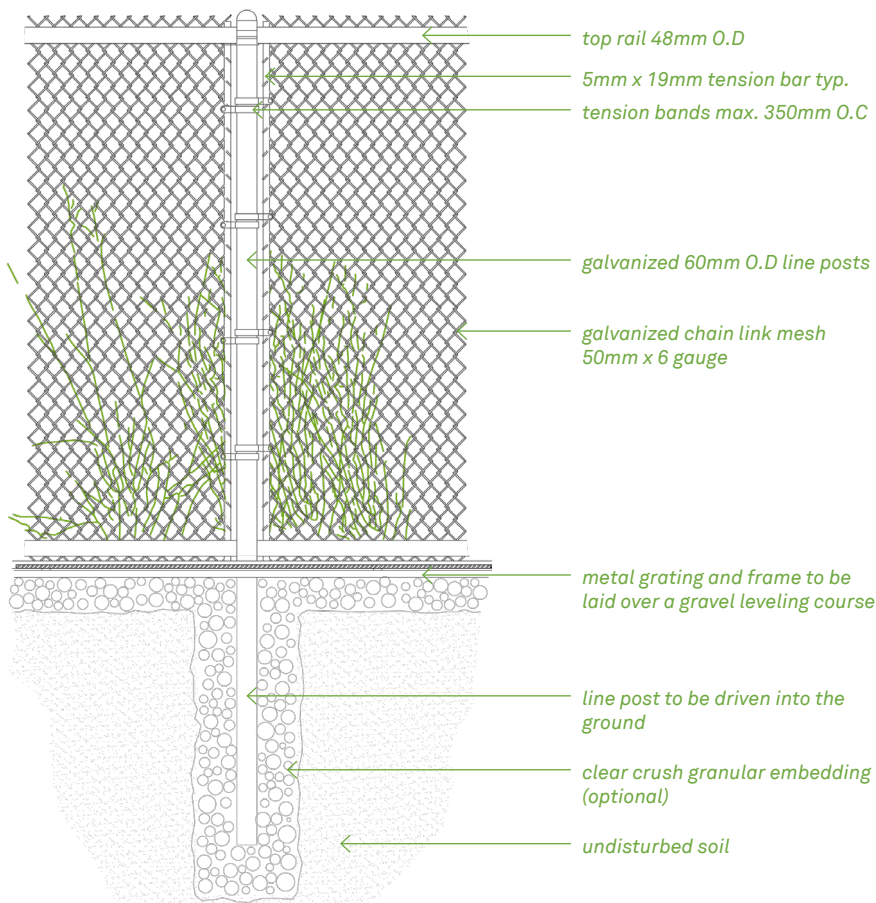

Chain link fence detail elevation view

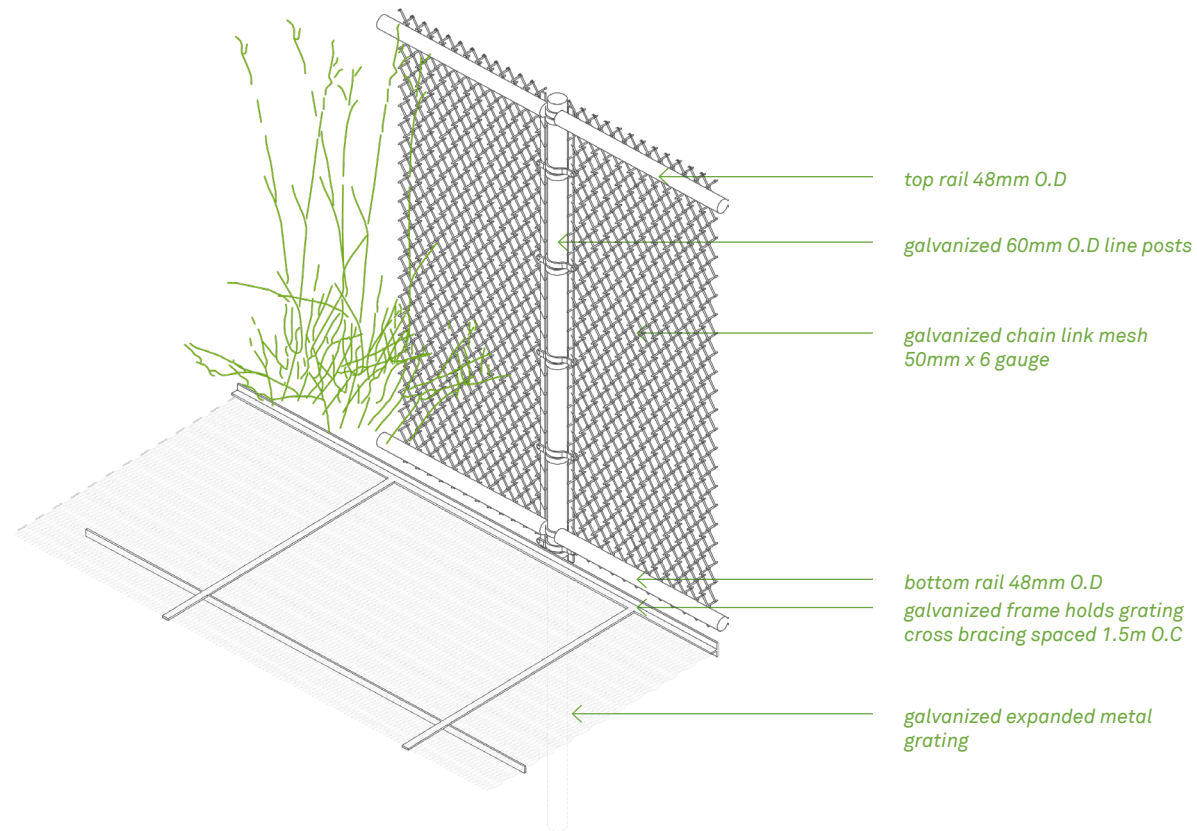

Chain link fence detail isometric view

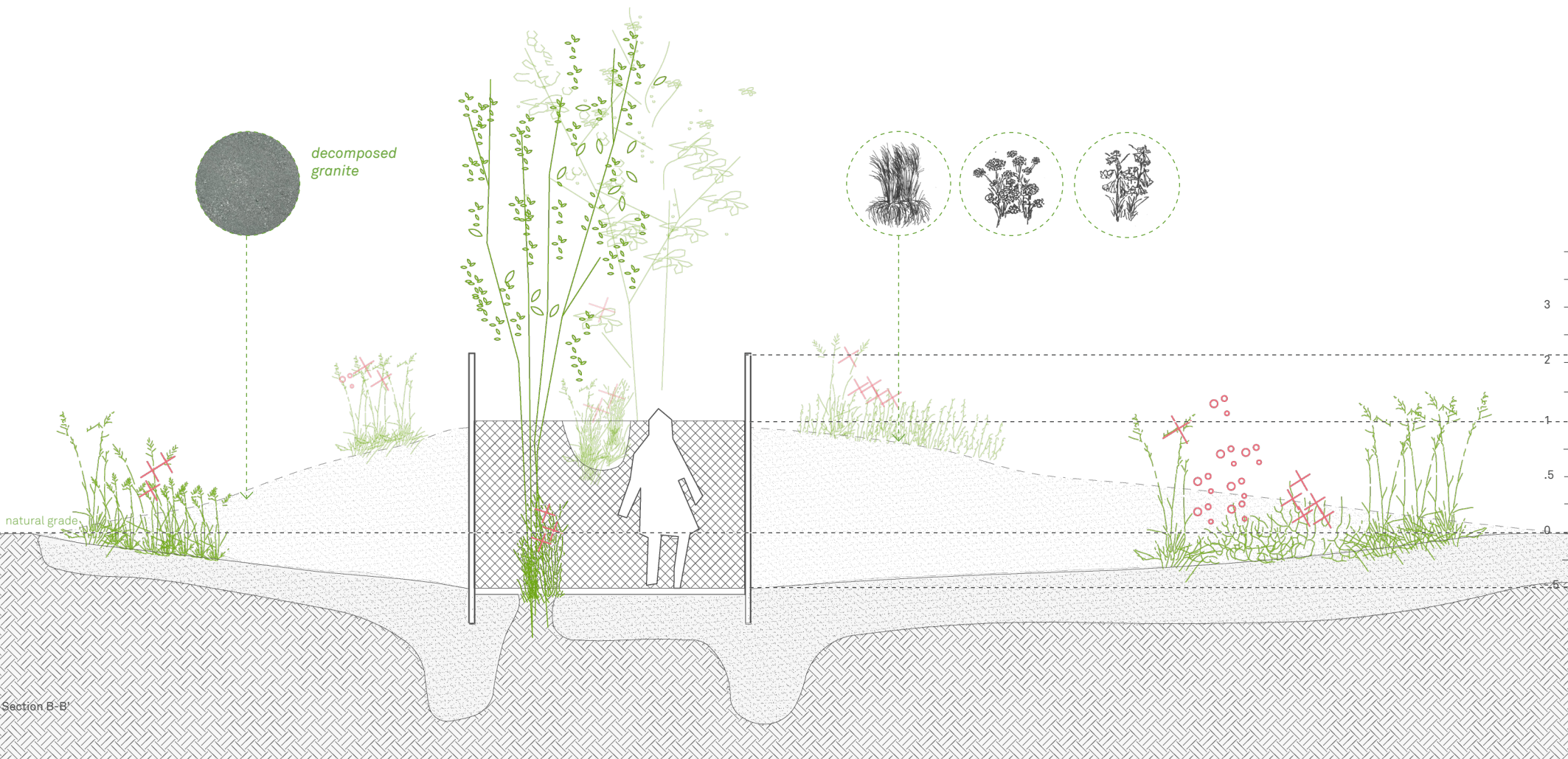

Flanked by vibrant, native and introduced perennials, the installation is surrounded by a space that feels both wild and cultivated, framed by flowering ground covers and tall grasses that intermingle across the boundary, blurring its definition.

An immersive blend of color and texture, from dense clusters of phlox and native goldenrods to airy blooms of verbena, envelopes the landscape being divided. A play of light through layers of delicate flowers and foliage softens the rigid metal lines, creating a harmonious dialogue between the wild and the industrial.

Visitors are encouraged to pause, reflect, and walk through the fence, experiencing both sides as a unified garden—inside, outside, and within.