

# Immersive Temporalities

*Immersive Temporalities* creates a garden in space and time through open dialogue with plant lives. We begin by expressing the human fixation with imposing abstracted order: a grid. We invite an assemblage of plants to willfully disrupt this structure, introducing delightful complexity. The ground is a field condition of living tree tissue. Trimmed birch twigs and branches slowly release nutrients and teem, in decay, with life. Birches above and below reveal the convoluted spectrum of cyclical growth. Planting several trees at angles nudges them toward unique spatial responses to an irregular starting condition.

We are eager to learn what they choose to do. Tilted trees create a microtopography of hummocks with sloped, exposed soil, breaking the plane of ramial mulch and hosting dense pockets of herbaceous plants. Soon, the finest twigs will have disappeared; fresh soil invites germination in new places. Periodic acts of care (pruning, collecting, scattering, planting) continue the conversation with plants to shape the garden. Weaving through the space, an intimate path of the same birch timber invites visitors to encounter dynamic plant rooms and characters.

- Plant List:**
- a. Yellow Birch *Betula alleghaniensis*
  - b. Red Twig Dogwood *Cornus sericea*
  - c. Mullein *Verbascum thapsus*
  - d. Milkweed *Asclepias syriaca*

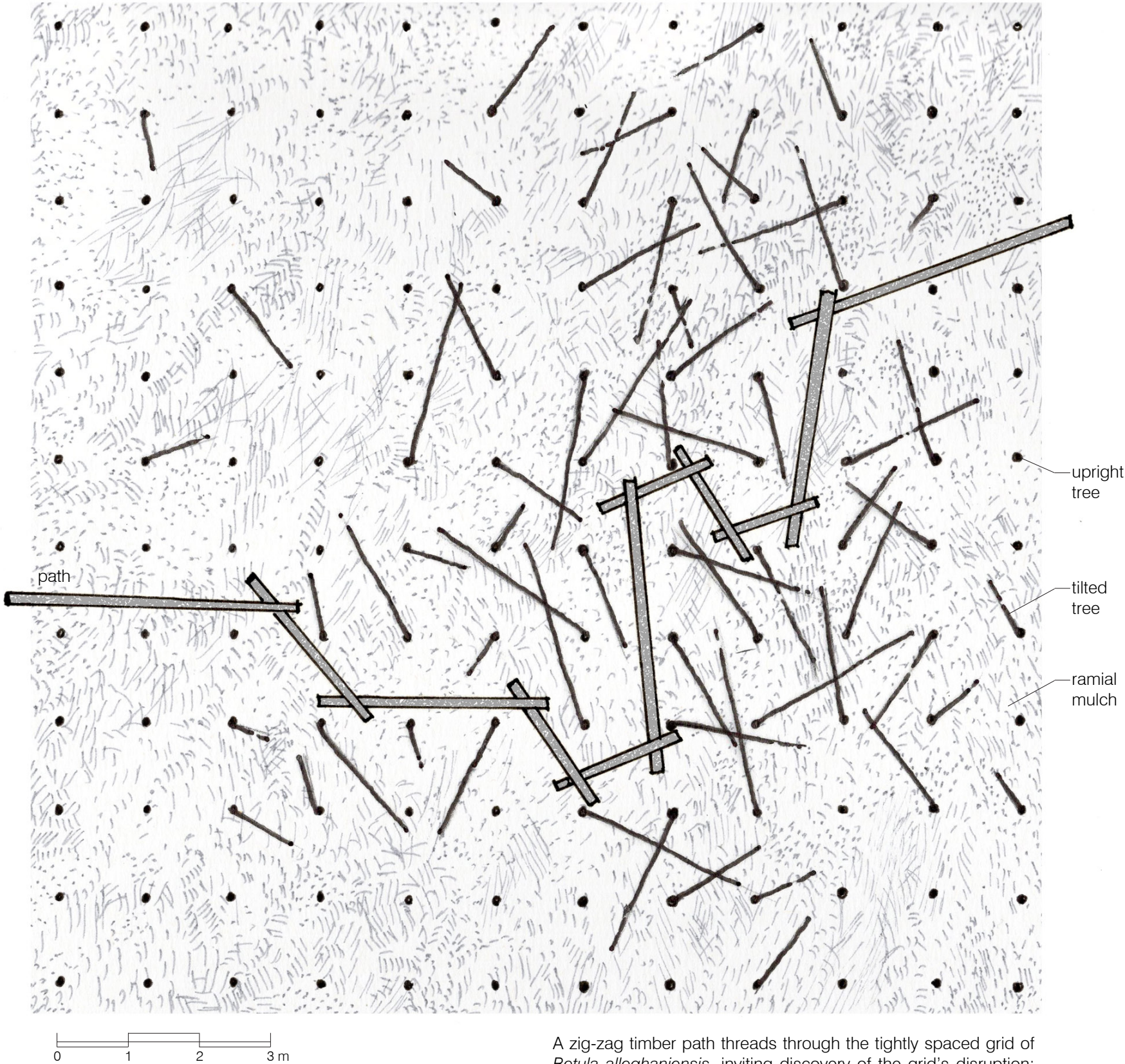

A zig-zag timber path threads through the tightly spaced grid of *Betula alleghaniensis*, inviting discovery of the grid's disruption: a constellation of trees planted at tilted angles. Light qualities will shift in this zone, growth will respond with anomalies, and herbaceous plants will add their lush selves.



Full scale mockup of un-chipped Yellow Birch ramial mulch. Ramial mulch using living branches smaller than 7cm supports the growth of living soil due to high nutrient content and slow release rate.



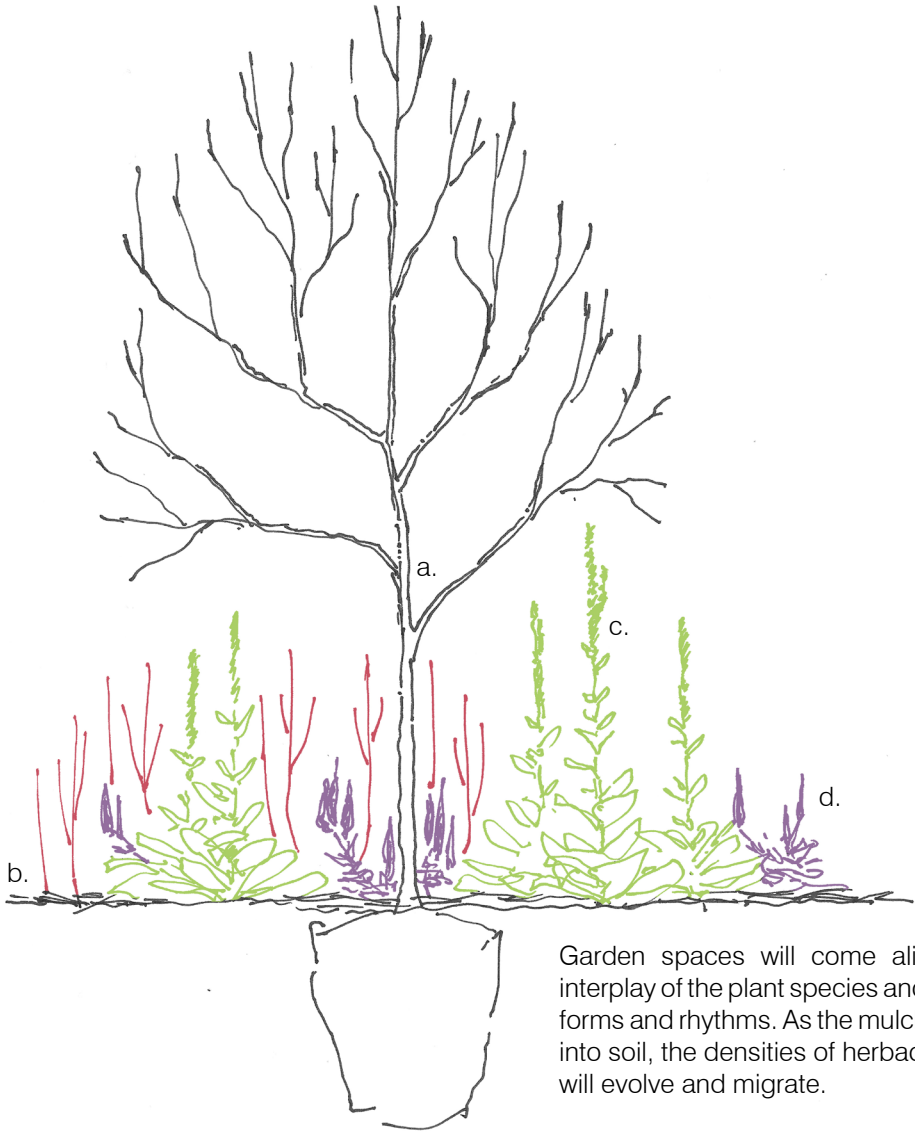

Garden spaces will come alive with the interplay of the plant species and their varied forms and rhythms. As the mulch transforms into soil, the densities of herbaceous plants will evolve and migrate.



Tilting the trees asks them to break free from the perfect shape they've been groomed for in the nursery and invites their improvisation. The flat groundplane breaks to accomodate roots.



domrancy  
solstice  
dream  
imagine  
root  
draw  
stratify seeds  
live stakes  
scatter  
last frost  
catkins  
equinox  
sprout  
sap  
leaf buds break  
leaf  
mullein  
germinates  
mycelial growth  
monarch eggs  
flower buds  
solstice  
redtwig flower  
plant containers  
refresh  
mullein flowers  
second year  
milkweed flowers  
monarchs depart  
first frost  
seedpods  
equinox  
birch nutlets  
seed collection  
foliage  
abscission  
seed  
root  
draw  
solstice  
dormancy