

Groundswell

Groundswell is a metaphorical journey that reimagines a single material, urbanite, the broken unwanted concrete leftover from demolition. The garden deconstructs one of the most ubiquitous elements of the modern world revealing its mineral components. Cracked and spilled for display, the garden asks the visitor to consider its materiality, its chemistry, and the mining of geological time.

The design imagines an earth event that cracks the surface. Shards of urbanite make way for fast establishing rye grass. The ground swells into landforms that spill sand, aggregate, and mineral elements. The landforms are quickly established by pioneering species; resilient mountain oregano, versatile bergenia, and towering prairie dock. The swells settle, the urbanite is stacked inviting new possibilities. Our material future is one of re-use and also of reverence.

Groundswell pays homage to the hardscape tradition of landscape design. It foregrounds the material that creates the path under our feet. The garden critiques unbridled extraction, and blind externalities. It celebrates the beauty and necessity of re-use, and speaks to the ecological possibilities once we crack the surface.

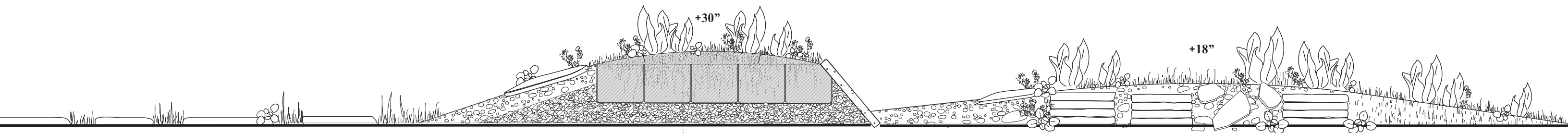
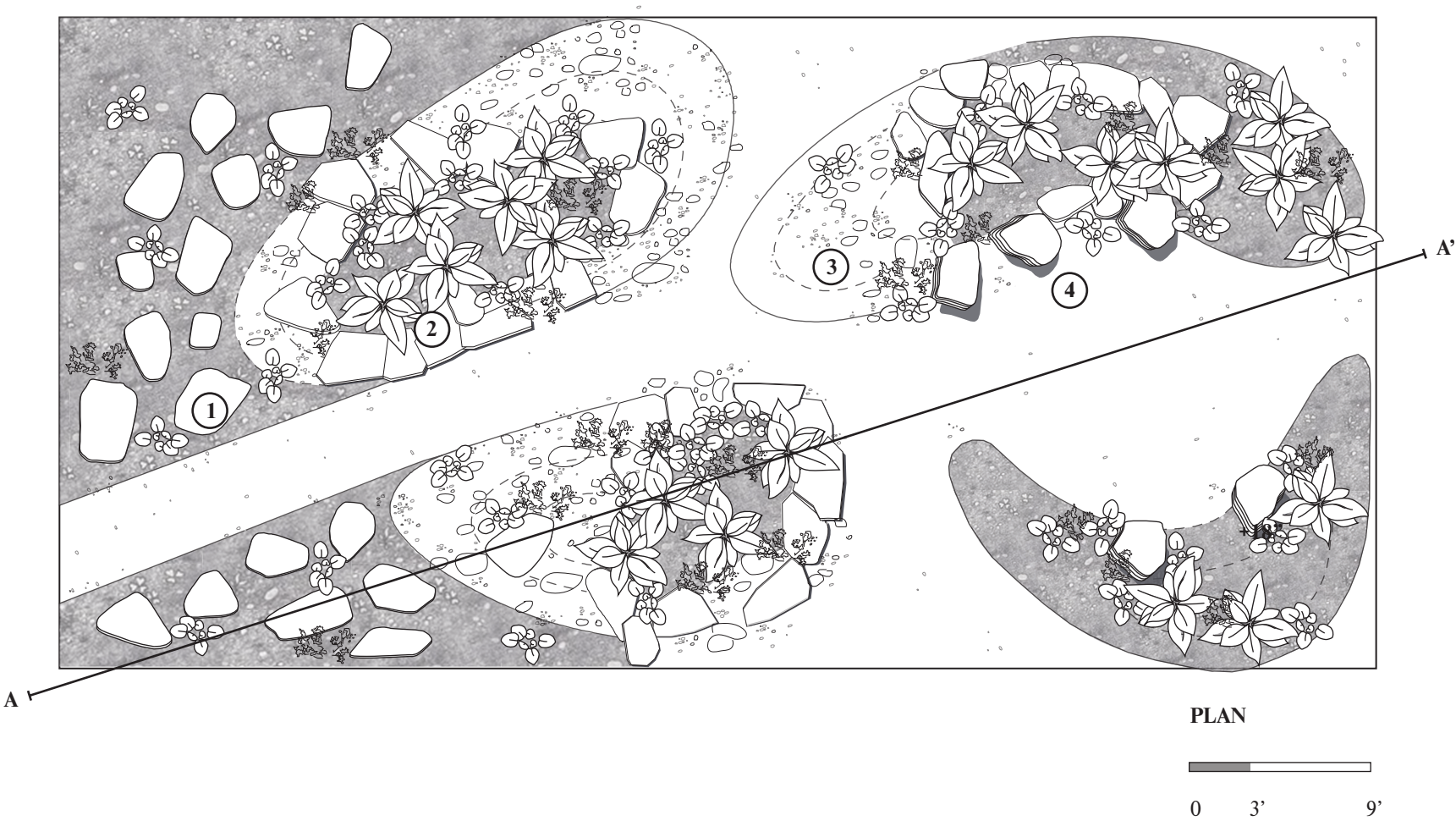

1. Crack
- Urbanite Shards set as Steppers;
Size roughly 18" x 30".

2. Swell
- 50 Gallon Plant Grow Bags
to build swell; Fill and top with
growing medium. Set on aggregate
leveling course.

- Urbanite Shards & Rubble
stacked to define swell edges.

3. Spill
Aggregate Mix:
- Sand
- 3/8" -1.5" Rock Mulch
- Crushed Sea Shells
- Limestone Chips
- Large Natural Silicate Minerals
- .5-1.5" Pyrite

4. Stack
- (4) 4" Urbanite shards; Stabilize
with mortar or rebar pin and epoxy.



01. Urbanite
10% air, 10% water, 30% sand,
40 % aggregate, 10% cement
-
02. Sand
Coarse or mortar sand
-
03. Seashell Aggregate
Oyster or Mollusk Shells
-
04. Gravel Aggregate
Mix of Coarse and Fine

05. Cement
Raw material mixture of calcareous and argillaceous material
-
06. Limechips
Minerals calcite and aragonite.
-
07. Chalk
A form of limestone composed of the mineral calcite.
-
-

08. Clay
Composed essentially of silica, alumina or magnesia or both.
-
09. Ai, Aluminum
Commonly alloyed with copper, zinc, magnesium, silicon, manganese and lithium.
-
10. Fe, Iron
The core of the Earth is thought to be largely composed of iron

with nickel and sulfur.
-
11. Ca, Calcium
The fifth most abundant element in Earth's crust.
-
12. Silica
Has three main crystalline varieties: quartz, tridymite, and cristobalite.
-
-

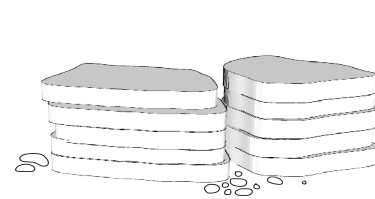

Stack
Urbanite shards; Stabilize with mortar or rebar pin and epoxy.



Swell
50 Gallon Plant Grow Bags to build swell



Origanum laevigatum
'Herrenhausen'



Elymus canadensis



Bergenia



Silphium terebinthinaceam