

YOU ARE NOT INVITED

In a world where nature often takes a backseat to human development, “You Are Not Invited” challenges garden norms. This project goes beyond a mere display; it is a statement about our place in the natural world, emphasizing the coexistence of humans, flora, and all organisms, while questioning the very essence of a garden.

At its core, the project features a rectangular dinner table supported by gabion cages, a symbolic centerpiece meant for natural succession to take place. The moss bed and vertical vegetation surrounding the table forms a natural barrier and stages the table for human visitors to witness, but not disturb. This stark deviation from expectations prompts a dialogue on the nature of our interventions in natural spaces and the concept of “invitation.”

Through the over-time form iterations, the project showcases the transformation from ‘the constructed’ to ‘the un-constructed’. As implanted seeds and fungi sprout, natural elements gradually consume the original surface. This metamorphosis invites visitors to engage with the ever-changing landscape of the garden and to consider their role in shaping or disassembling it. It poses fundamental questions about what a garden can be and what it should represent, offering an intimate and evolving narrative that encourages us to embrace the complexity of the world around us.

Plant List

The Table:



Low Bush Blueberry
Vaccinium angustifolium



Wild Strawberry
Fragaria virginiana



Dwarf Raspberry
Rubus pubescens



Common Blue Violet
Viola sororia



White Wood Aster
Eurybia divaricata



Butterfly Weed
Asclepias tuberosa



Western yarrow
Achillea millefolium
var. *occidentalis*



Daisy Fleabane
Erigeron strigosus

The Ground:



Atrichum Moss



Polytrichum moss

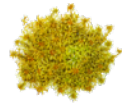

Sphagnum Moss



White Clover
Trifolium repens

The Shelter:



Swamp Milkweed
Asclepias incarnata



Cotton Grass
Eriophorum virginicum



Wild Indigo
Baptisia australis



Ostrich Fern
Matteuccia struthiopteris



Meadow Fescue
Festuca pratensis



Swamp Aster
Symphotrichum puniceum

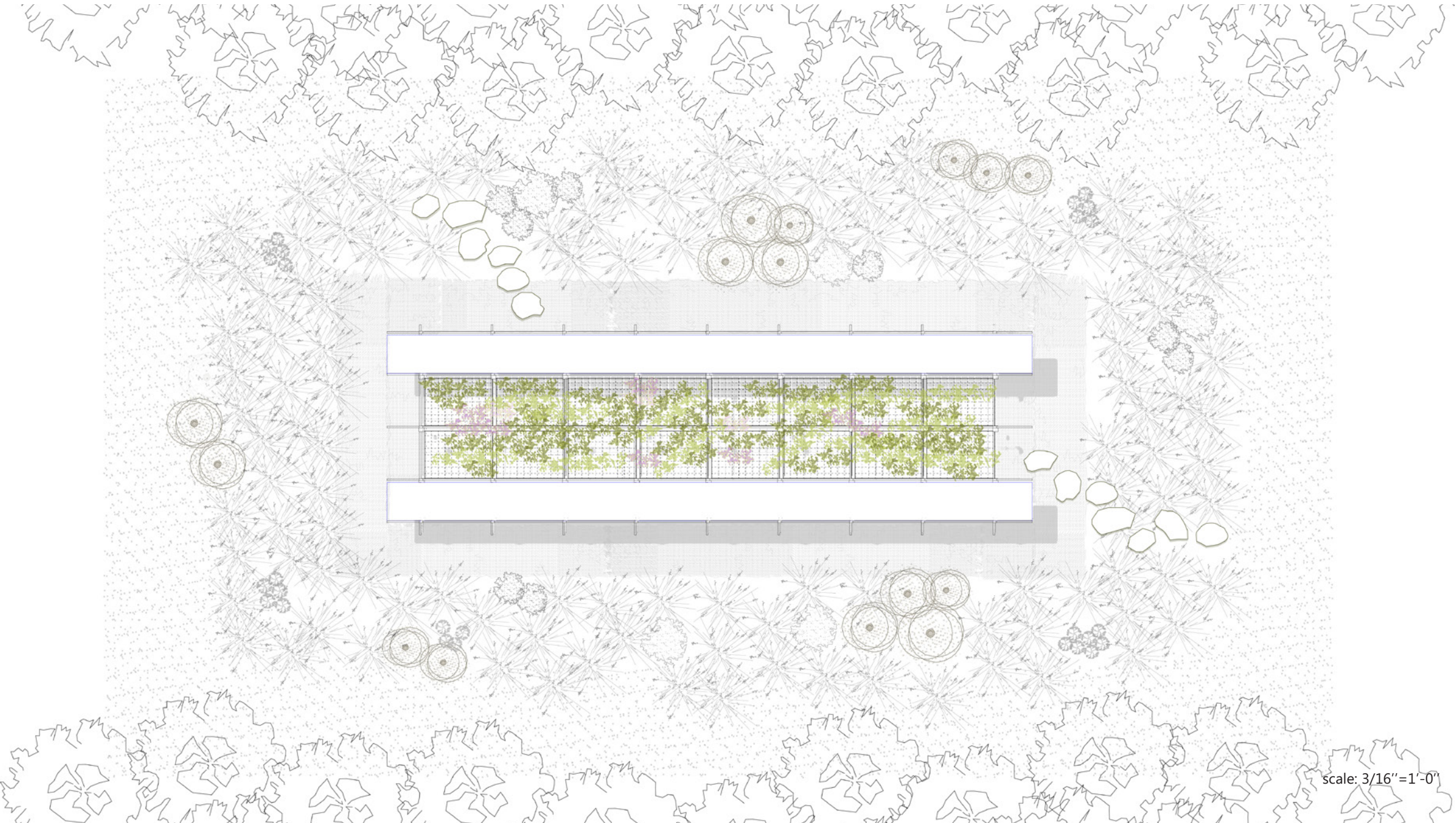

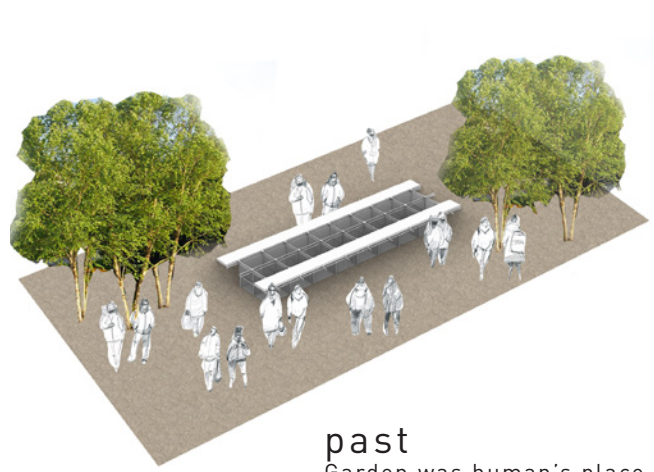

past
Garden was human's place

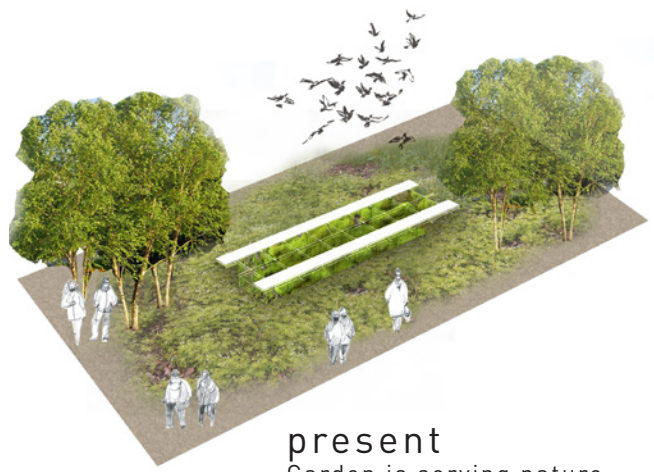

present
Garden is serving nature -
a party for wildlife habitat



future
Garden will become natural
composition

Elevation

