

PLAN OF THE INSTALLATION
scale 1: 100

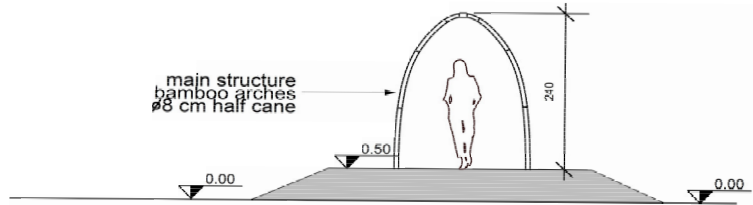

SECTION B - B

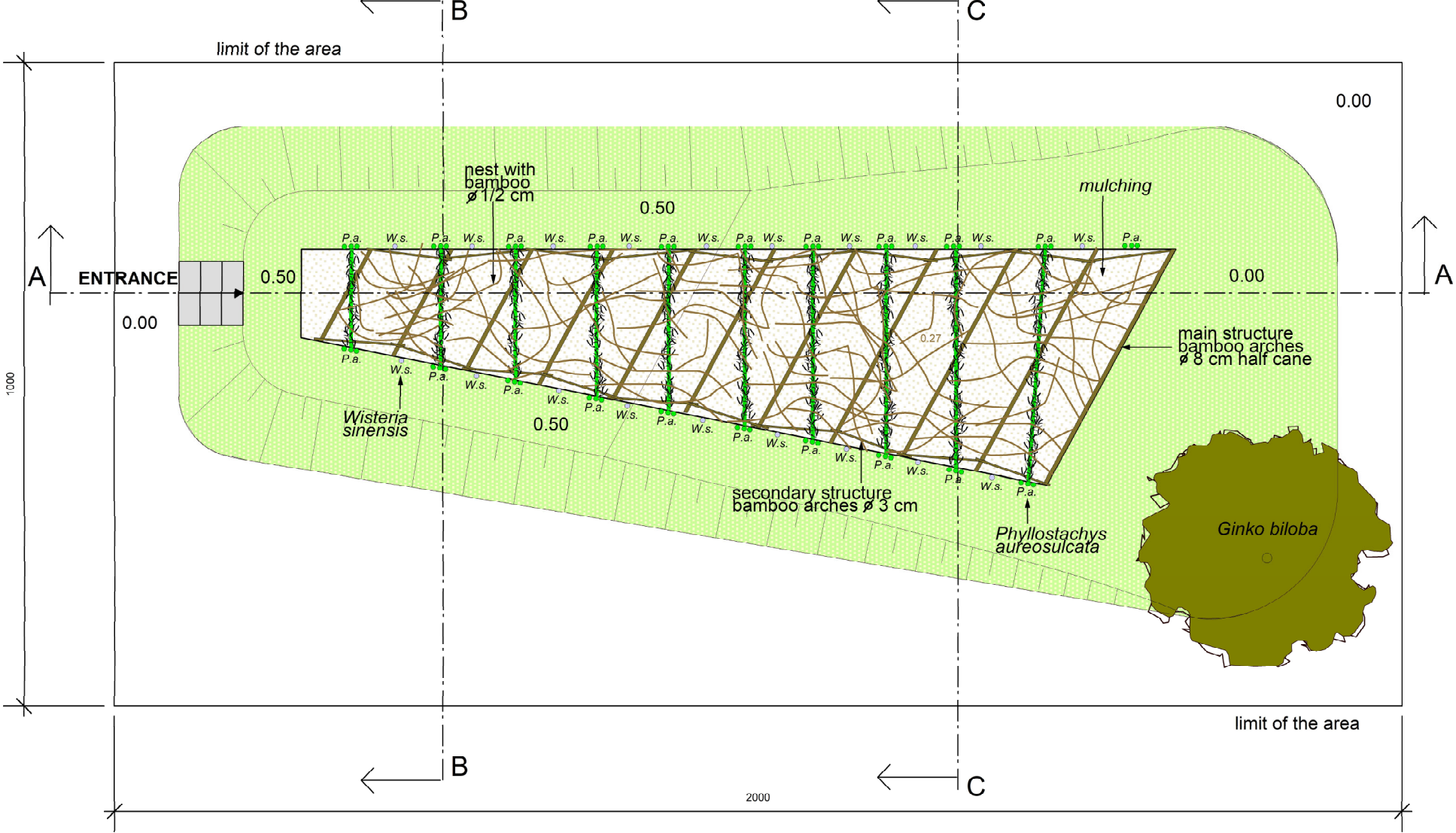
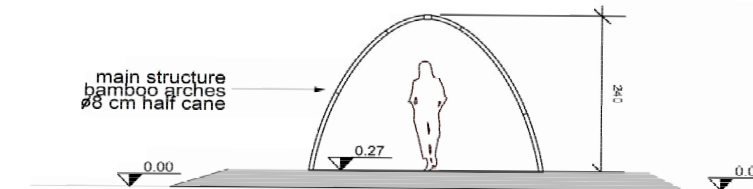

SECTION C - C

PLANT SPECIES



Phyllostachys aureosulcata



Wisteria sinensis

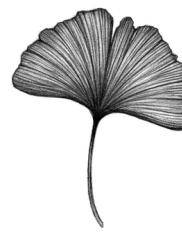

Ginkgo biloba

“Everything that is unknown is imagined to be full of wonders” (Tacito)

The ability to wonder belongs to the free man, curious and capable of dreaming.

To those who are not afraid to rely on their emotions. However, it is not easy to travel through a tunnel where you don't know where it leads. The scenario at the end of the journey can be the same as the one at the beginning, better or scary.

It is essential to be aware of the risks you run when you embark on an unknown path, but it is necessary to implement a strategy that allows you to modify, if not even cancel, the action

taken. Inside each observer, who begins the action of the journey, lives the inner wonder. At this point we suggest breathing and then choosing the most congenial rhythm to cross the tunnel.

As you get closer to the exit you will be able to discover infinite possibilities, but only one can be experimented with and it will make all the others inconsistent.

The glade with the solitary Ginkgo generates dichotomies between matter and perception, between inside and outside, between body and soul.



Tunnel view

DEVELOPMENT STEPS

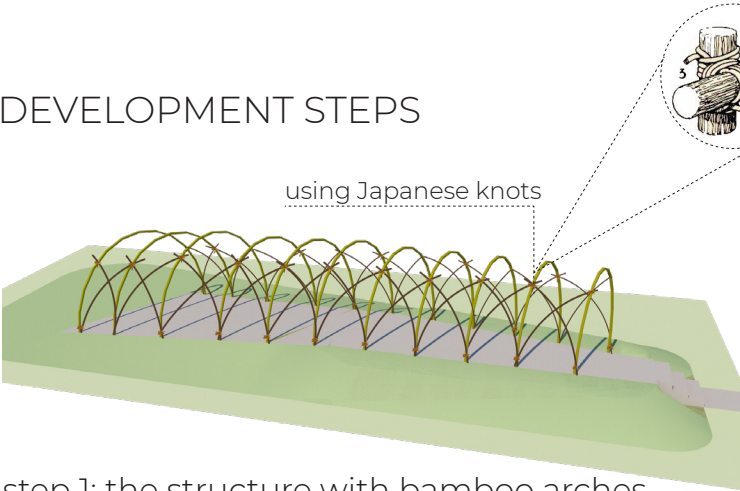

step 1: the structure with bamboo arches

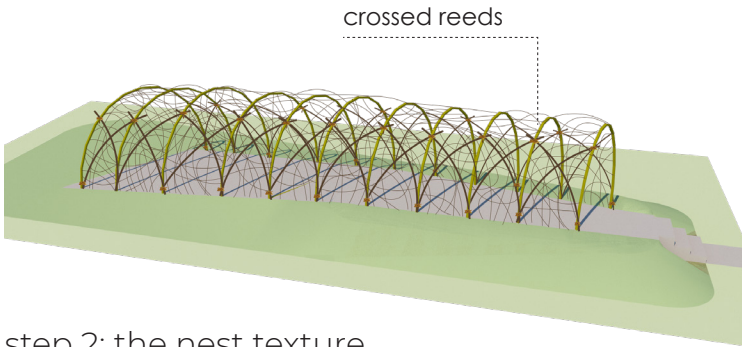

step 2: the nest texture

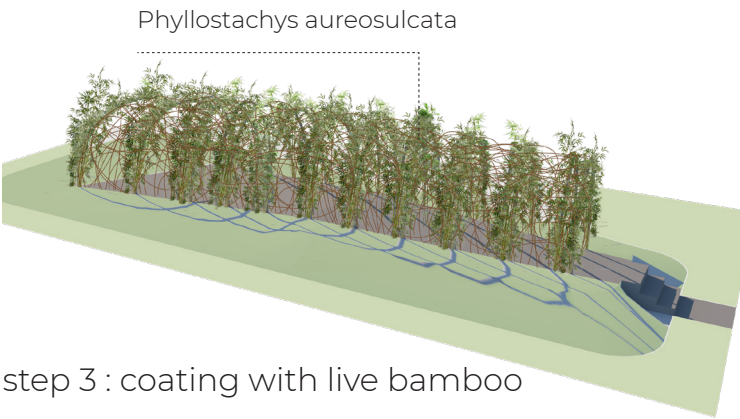

step 3: coating with live bamboo

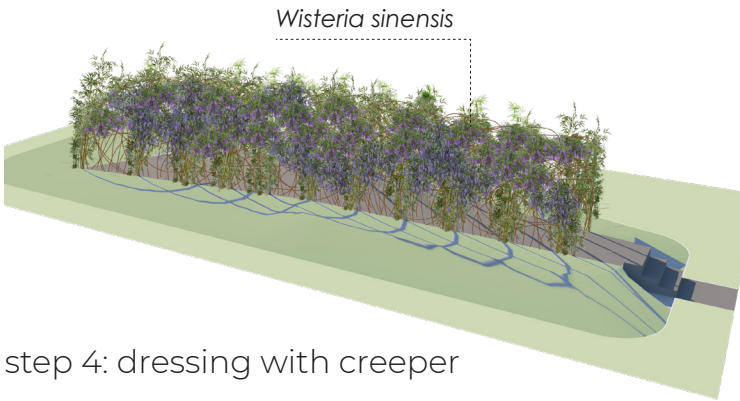

step 4: dressing with creeper

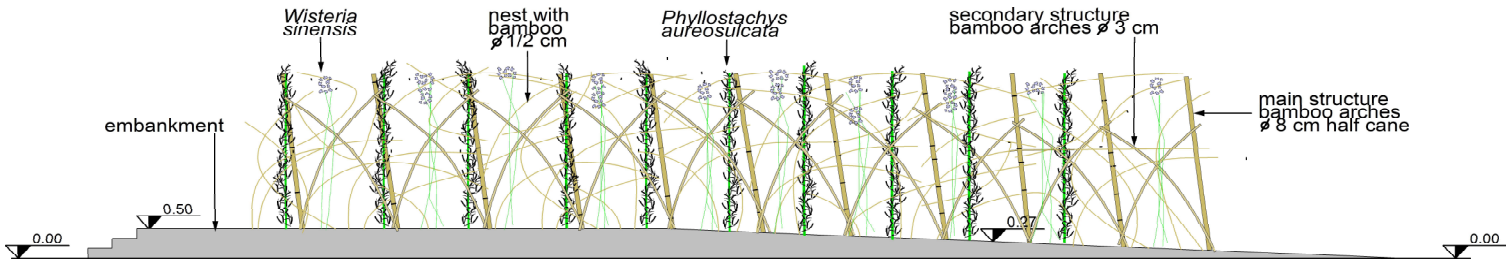

SECTION A - A



The beginning of the path