

UNSEEN On Earth 71% of the surface is covered by water, while only 29% is land. Our anthropocentric perspective, leads us to consider only land as our environment, while in fact, land continues under the water surface, adapting itself and its whole ecosystem to a different condition that just doesn't belong to humans.

This project is a celebration of what is unseen, of other perspectives on the environment, that are urged to be included, if we want to build a new relationship with the planet.

We designed an abstract surface fully occupying one of the plots in the north-south axis (10x20 m) to represent Earth. On this surface we cut 7 holes, representing the 7 continents, hence land. We've then imagined to lift up the short sides of the surface, to reveal what's underneath, to show the submerged land, treating it as a different type of garden. People are invited to walk over this *carpet* made of different types of soil, pebbles and sand, to assume a different point of view, re-evaluating the concept of gardens and re-thinking our planet as one connected ecosystem. The larger holes allow people to cross from underneath the surface, to the top of it, in order to experience this change of perspective.

No green, grass or plants then, but a variety of soils, pebbles, sand, gravel, stones, to represent a different kind of beauty: literally the often forgotten side of a garden, figuratively a forgotten side of the planet.

The circles will be filled with coloured glass pebbles, representing sand transformed by human action, while the rest of the carpet will be made by a variety of materials represented here:



TOP PLAN (surface)

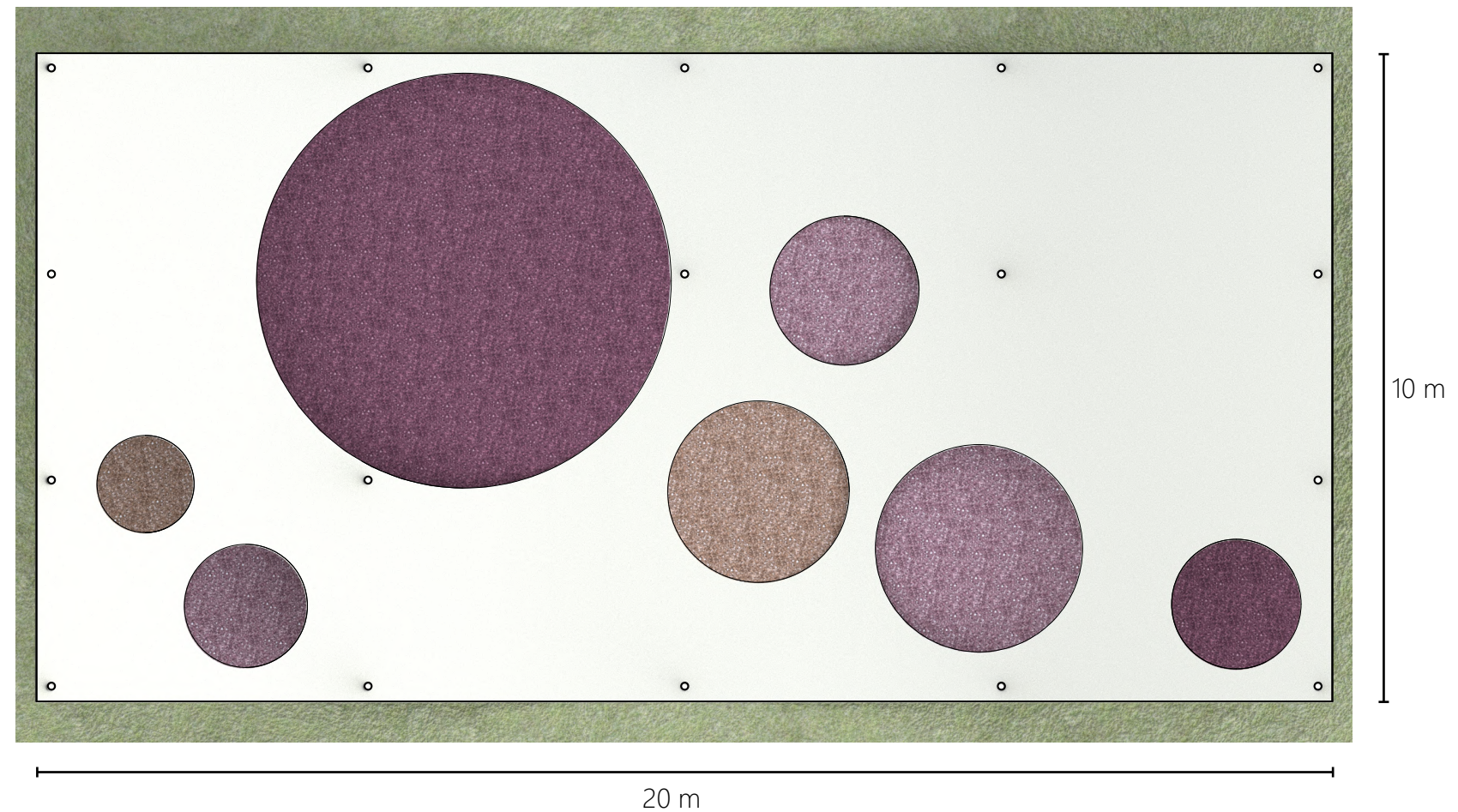

BOTTOM PLAN (garden)

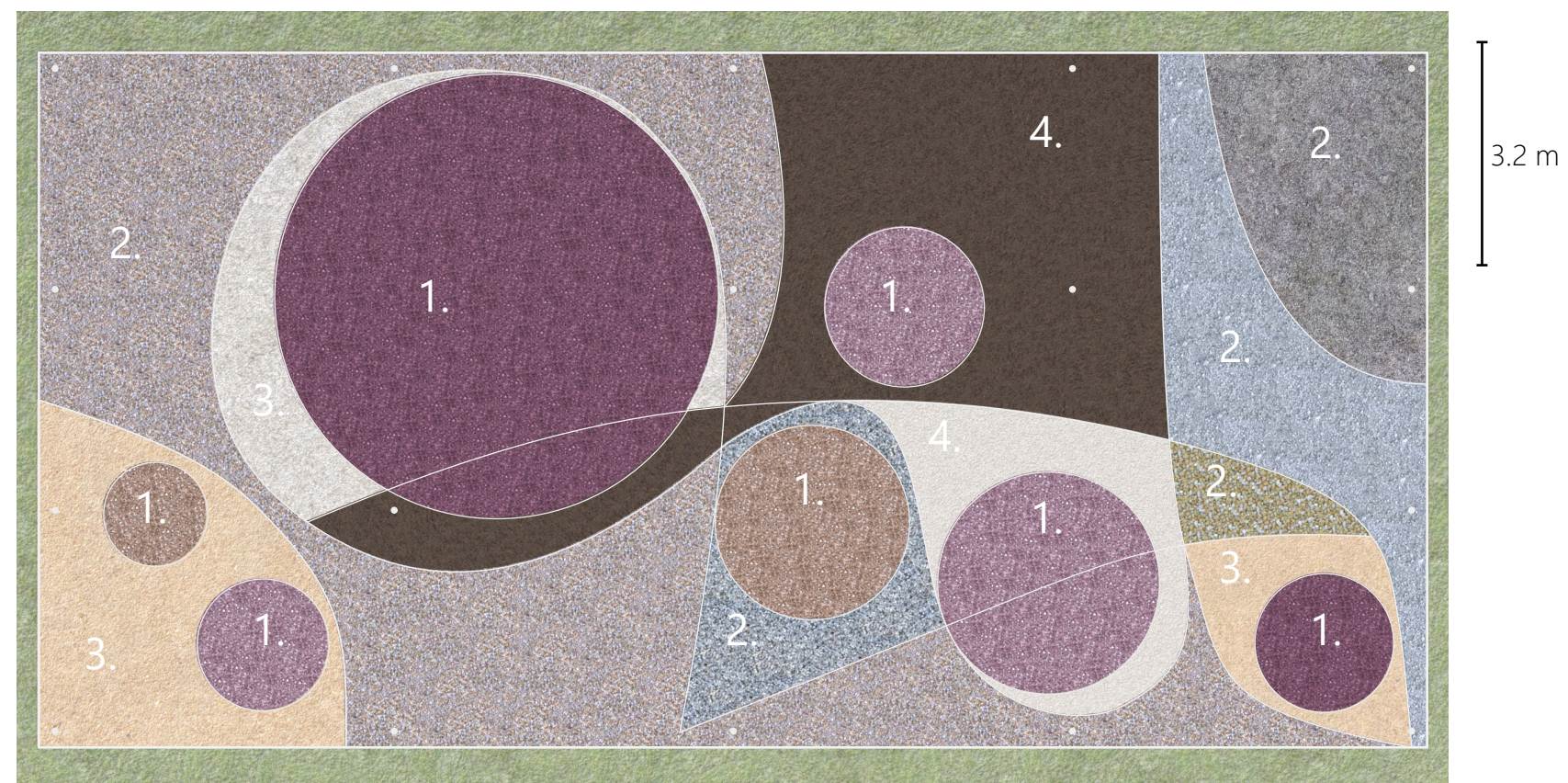

LONG SIDE ELEVATION

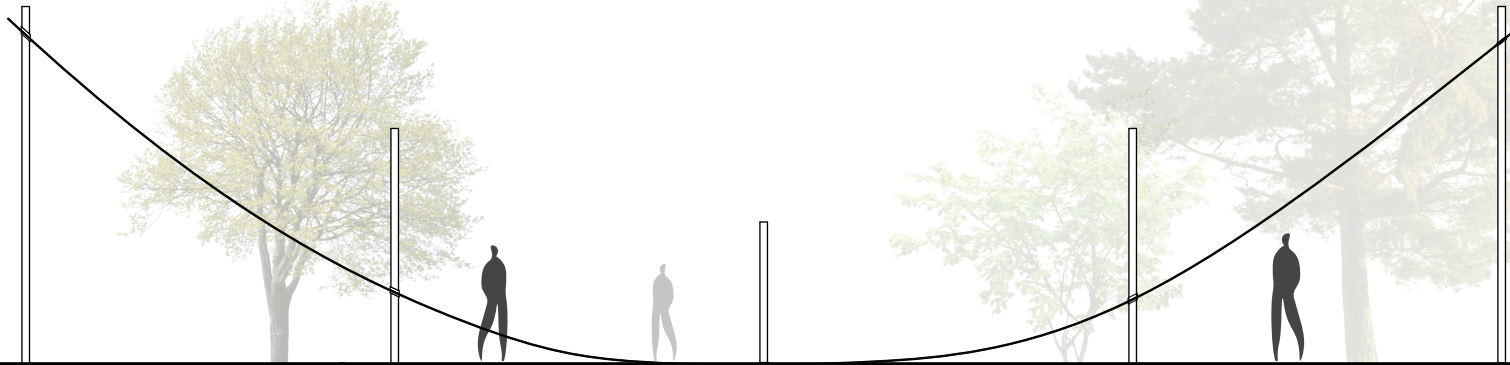

SHORT SIDE ELEVATION

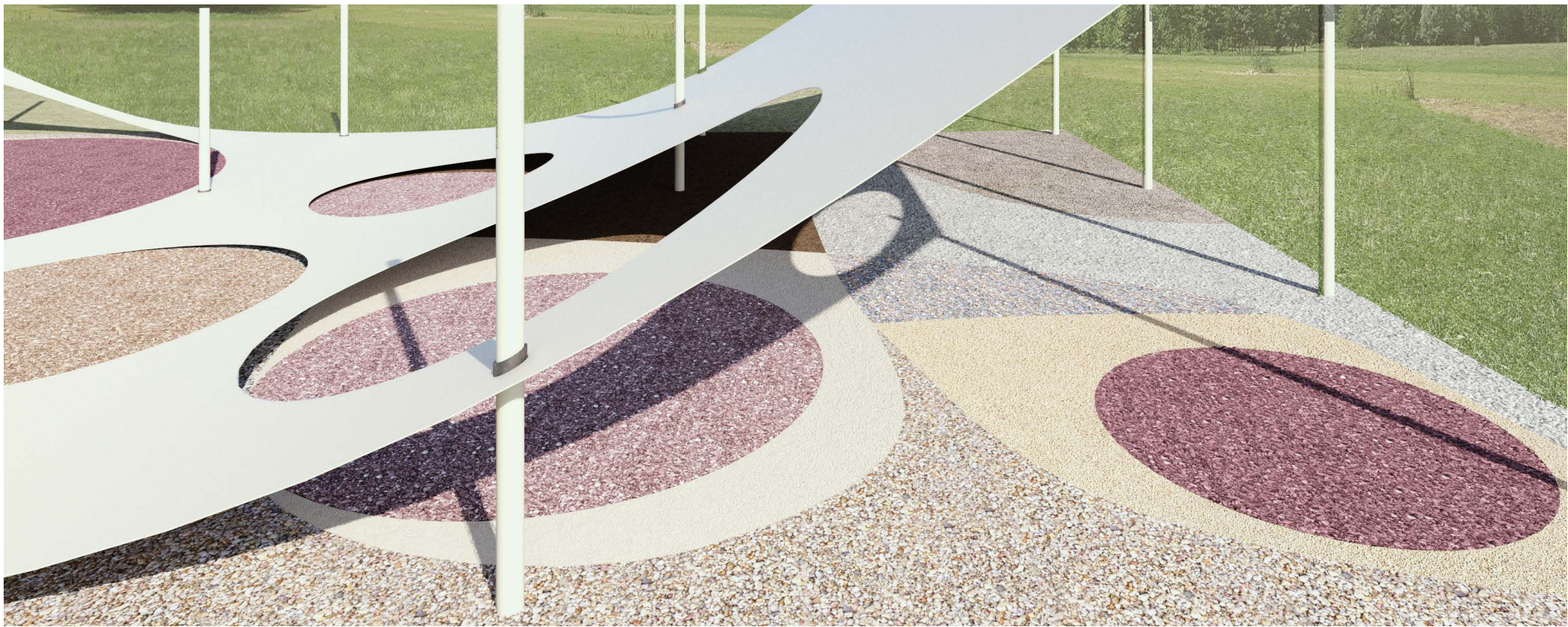
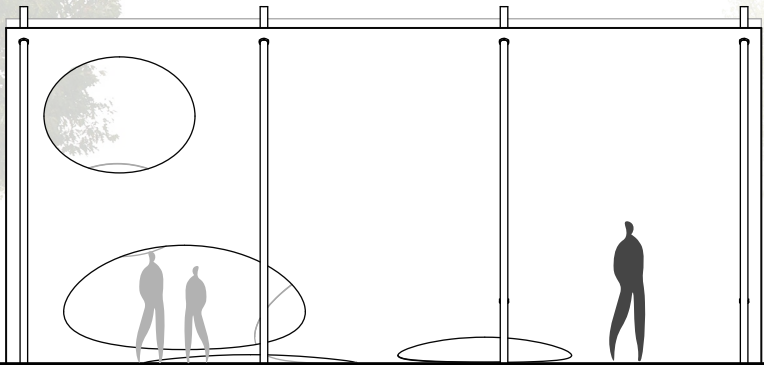

waterproof canvas

to represent the water surface we chose an abstract white surface, a waterproof cotton/pvc canvas onto which cutting the holes. This cloth will be fixed to the columns through a series of metal eyelets.



columns

a grid of white columns with a decreasing height towards the centre, will support the canvas.
A fixing ring will be placed on each column, at the right height, to provide a support to the eyelet on the canvas, that will be slotted in, and then fixed.