

ESPACES D'ESPÈCES

OR, BIRDS LOVE BIRCHES

The garden is an inhabited landscape where the interaction between multiple ecologies and multiple species becomes most apparent. The time we spend inside of a garden teaches us about the habits of different flora and fauna, of the kinds of spaces they enjoy and which they help to flourish.

We propose a design in which one can experience some of these habits, and which is simultaneously habitat and resource. Planters at different heights allow native plants with different sun and shade requirements to grow, which provide food for birds, bugs, and mammals. Trees are interspersed, providing cover, material, and habitat. A path weaves underneath houses for birds and bats, and leads to an observation blind where a visitor can rest and look into the foliage.

The future of gardens should nurture their own interconnectedness and foster a conservation awareness and knowledge of the needs of other living beings. For us, an ecology of possibilities is one where human spaces make spaces for many species.

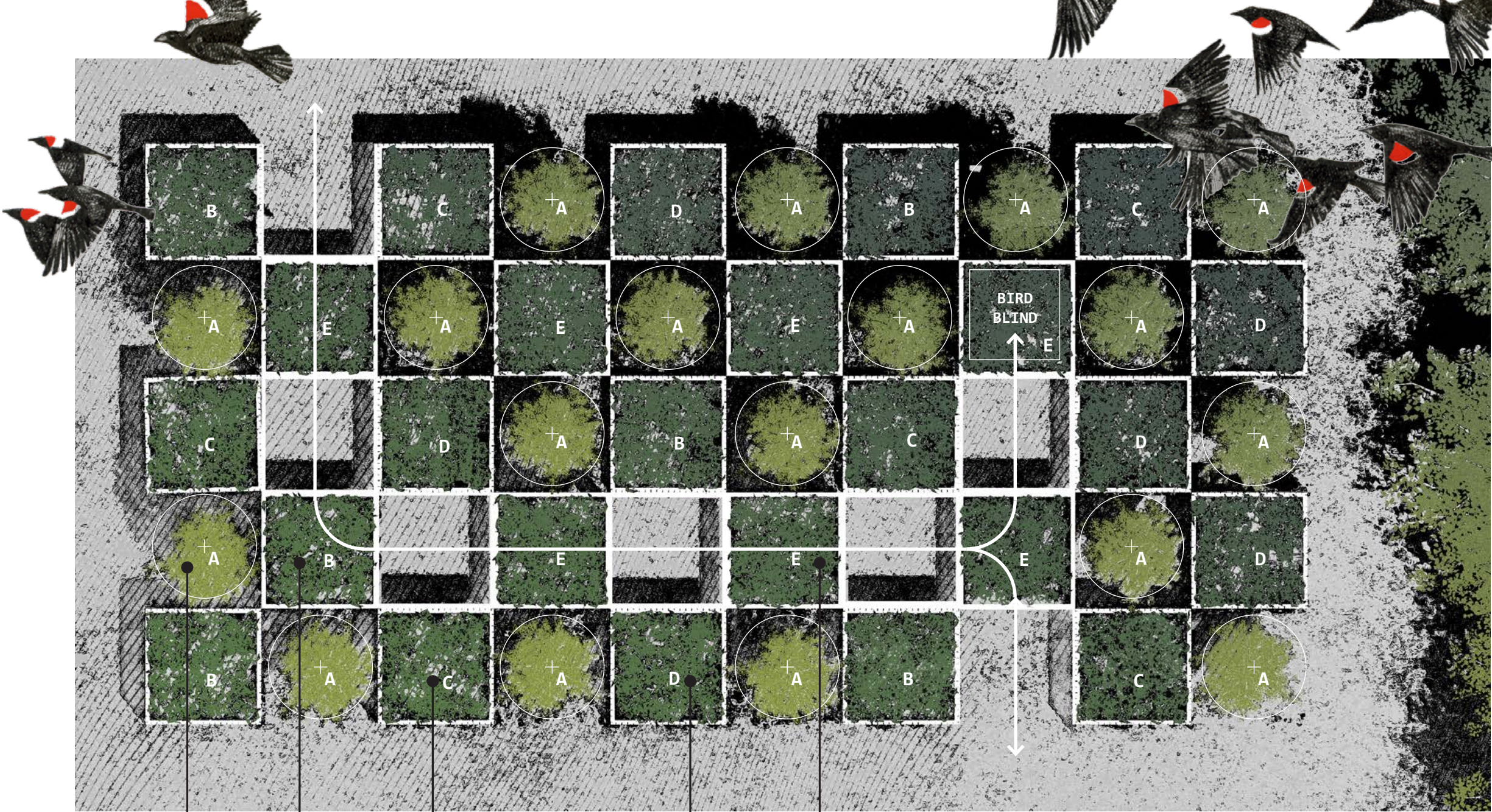

SPECIES SELECTION

Regional birch, shrubs, and grasses provide a feast for native wildlife.



A Paper birch (*Betula papyrifera*)
Attracts butterflies and birds



B Blue vervain (*Verbena hastata*)
Attracts pollinators, butterflies, and birds



C Black chokeberry (*Aronia melanocarpa*)
Attracts pollinators and birds



D Canada serviceberry (*Amelanchier canadensis*)
Attracts pollinators and birds



E Big bluestem (*Andropogon gerardii*)
Attracts pollinators and birds





The habitat is a zen and peaceful maze.

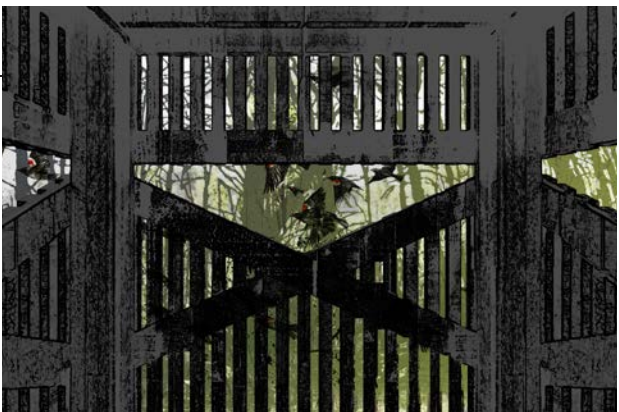

BIRD BLIND

Visitors can observe birds without disturbing them by climbing into the tall blind.



The structures are made of carbon-neutral silvered wood.



BIRD FEEDER BIRD HOUSE BAT HOUSE

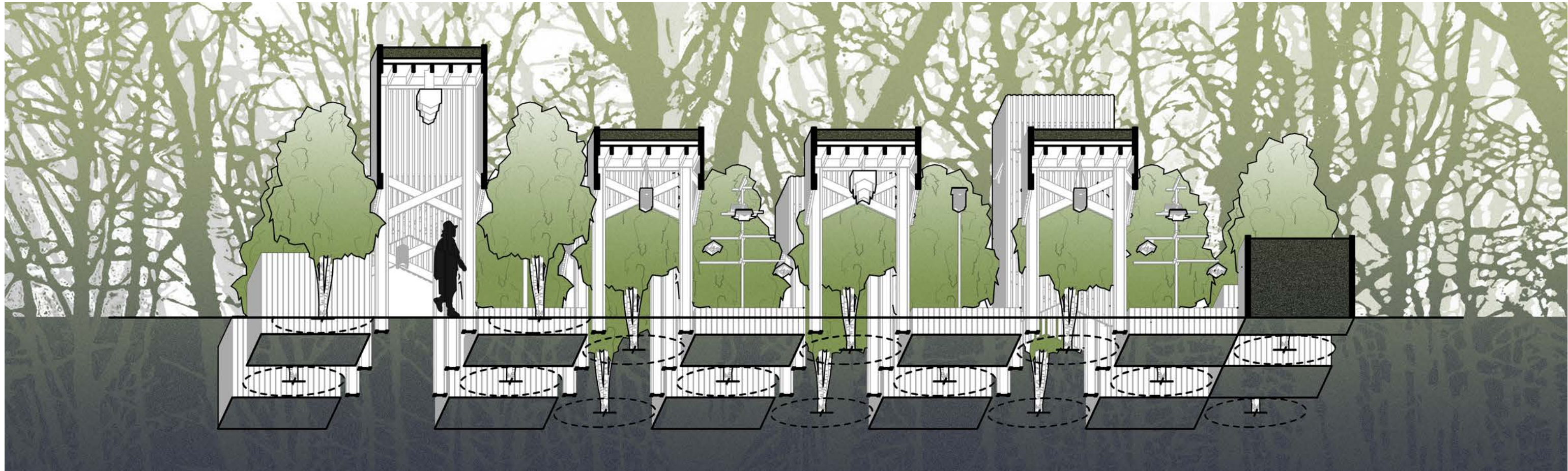

Elevated planters create protected airspace for nest boxes and let visitors walk under the habitat without disrupting it.

SECTION - WORM'S EYE PROJECTION