

# DEGRADATION and REGENERATION

## DESIGN CONCEPT

We illustrated our understanding of roots into the flexibility of contrasting concepts embedded into inclusive forms - regeneration and degradation; indigenous culture and colonization. Parametric grids, made of easily degradable, recycled wood material, depicts and abstracts representation of the oppressions from colonization in mixed cultures. While organically shaped landforms of native soil bed presents projects one's nativeness and originality. Along with the inclusive topological design, the vertical process of regeneration and degradation adds the dimension of root to our narrative - as geometric wooden structure decomposes into the soil surface, fast-growing moss and trees flourish, and reflective plaster installed in depressions reflecting tree canopy ties nourishment and degradation into one cycle of the root. Living in the vastly changing world where all cultures and identities are melting into one pot, we hope people may experience retrospect of their originality from their eye level in a securely enclosed space of inclusivity.

## PLANT SELECTION

*Cornus alternifolia*  
*Corylus americana*  
*Populus tremuloides*

Pagoda Dogwood  
American Hazelnut  
Quaking Aspen

## MATERIAL SELECTION

Armour Stone  
Recycled Wood

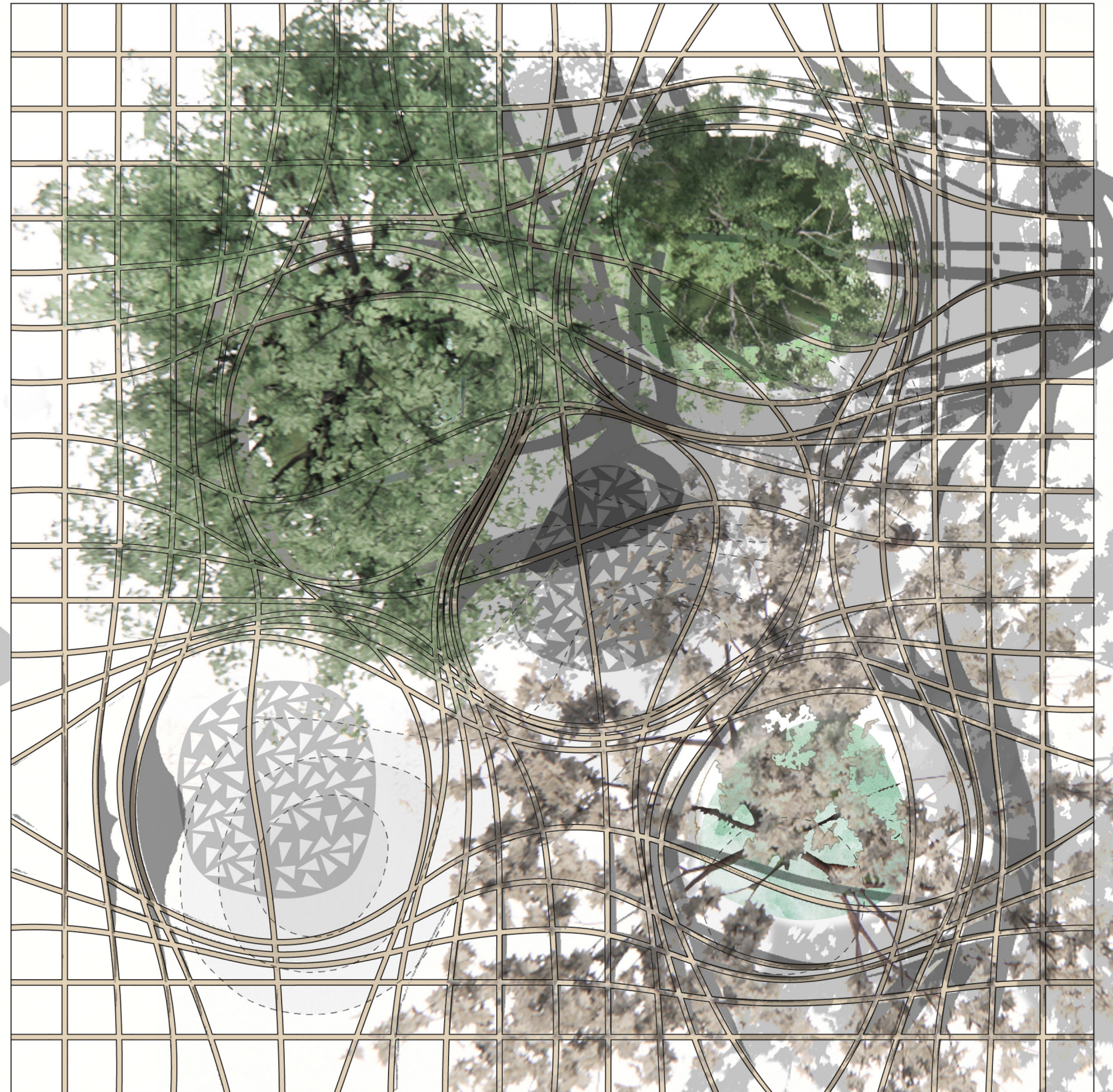

Plan 1:50





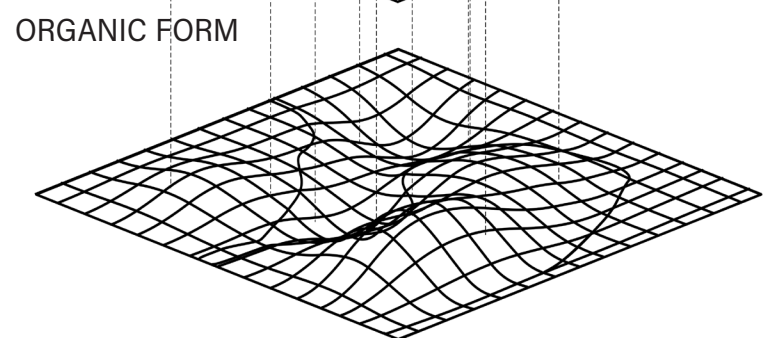
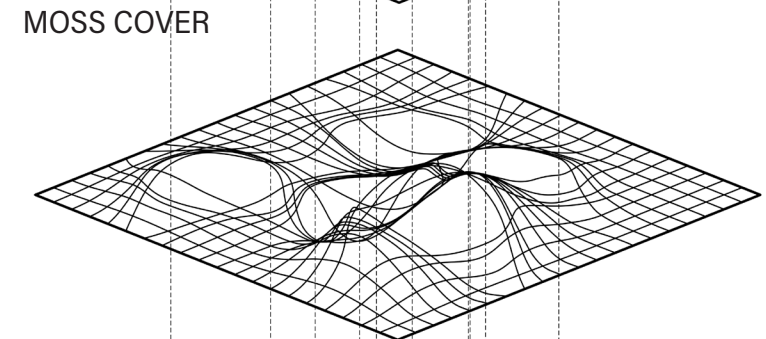
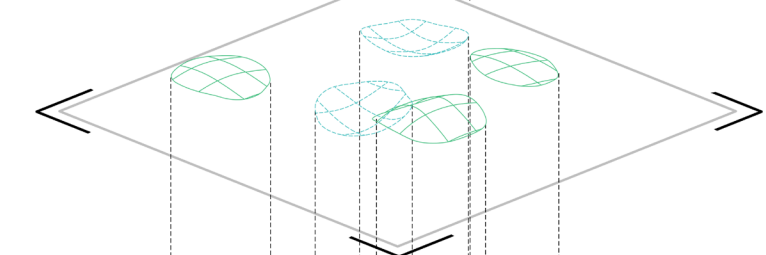
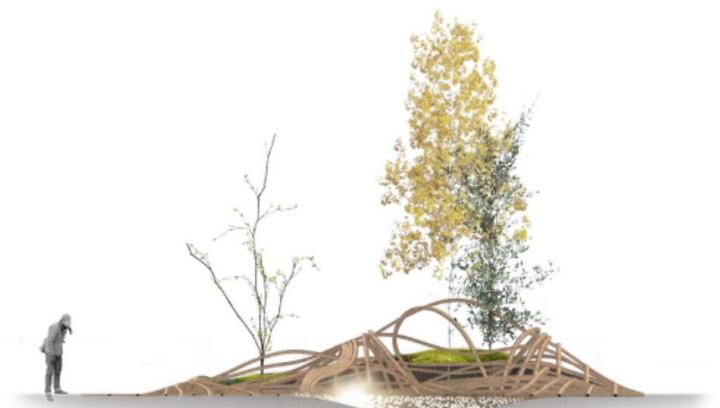
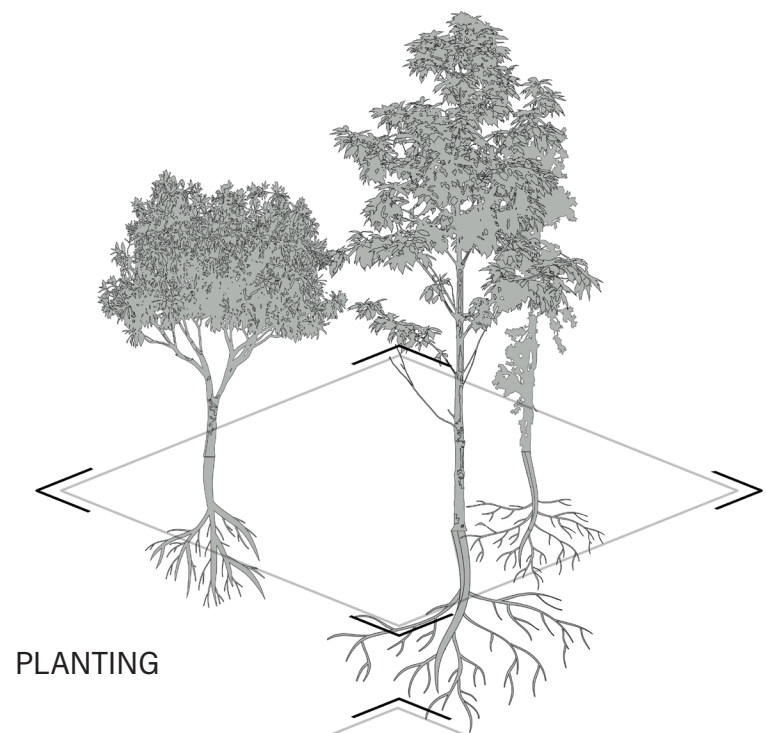

DEGRADING AND NOURISHING PROCESS